

4X6 SPACE MASTER WITH DOUBLE DOORS AND METAL ROOF ASSEMBLY MANUAL

Version #1.0
May 29, 2023

Stock Code:
SM46-D-TG-METAL

Thank you for purchasing a 4x6 Space Master. Please take the time to identify all the parts prior to assembly.



Important Information:

- It is the sole responsibility of the customer to check with your local municipal or county by-laws before ordering this product to confirm it complies with building codes in your area.
- If the product is elevated, any structural and building code requirements are solely the customer's responsibility, and should be abided by.
- Snow load ratings vary by geographical location. If heavy or wet snowfall occurs, it is advisable to sweep snow off roof frequently.
- In areas with high or gusty wind conditions, it is advisable to install the structure securely to the ground.
- Have a regular maintenance plan to ensure screws, doors, windows and parts are tightly affixed.
- All structures purchased from Outdoor Living Today are covered for a period of one year for defects in manufacturing and workmanship. Costs incurred for customer installations are not included.
- Failure to use supplied parts included in this kit could result in poor product performance and may void your warranty. Please contact Outdoor Living Today's Customer Toll Free Line if you plan to deviate from our written instructions.

Customer agrees to hold Outdoor Living Today and any Authorized Dealers free of any liability for improper installation, maintenance and repair.

In the event of a missing or broken piece, simply call the Outdoor Living Today Customer Support Line @ 1-888-658-1658 within 30 days of the delivery of your purchase. It is our commitment to you to courier replacement parts, free of charge, within 10 business days of this notification. Replacement parts will not be provided free of charge after the 30 day grace period.

What to do before my Shed arrives?



- Become familiar with this assembly manual and determine if you can complete the project yourself or will require a professional contractor.



- One helper is recommended to assist in constructing your chalet. It generally takes two people less than a day to assemble a chalet. If you're hiring a contractor, their rate should be in line with that duration of work.



- Clear the construction area and ensure a clear pathway for delivery when the freight company arrives. Remove all debris: roots, grass, rocks, etc.



- Excavate the site. Contact your local utilities company to ensure there are no gas or electric lines buried in the area before digging.

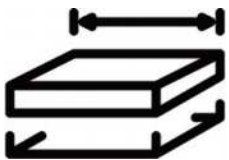

- Decide on the type of foundation you will be using:
 - Concrete slab, or
 - 4-6 inches of crushed gravel with paver stones or 4x4 stringers.

You can find the footprint for your shed on Page 3 of your Assembly Manual.



- If doing the assembly yourself, have all the necessary tools ready to go and in working condition. A list of required tools can be found after the parts list.

Foundation Types for 4x6 Garden Shed

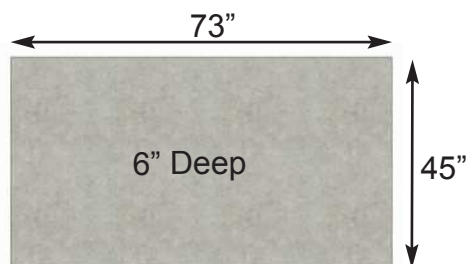

Concrete Foundation

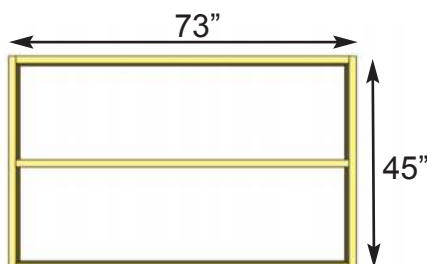

Floor Frame



Completed Foundation

Concrete Slab Foundation:

- Slab must be at least the same size as assembled floor frame (45" x 73") or larger.
- 6" Deep foundation.
- 0.5 Cubic Yards of concrete required.
- A concrete slab will have the longest durability out of your foundation options.

Once level, a concrete slab is the easiest surface to build on.

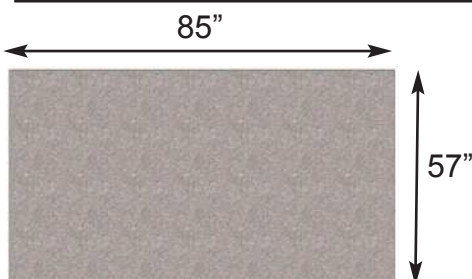

Gravel Foundation

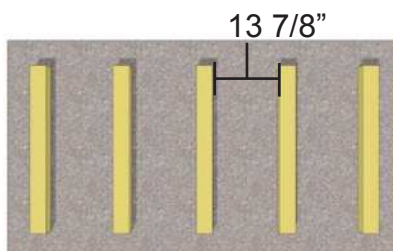

5 - 4"x4"x44 3/4"

Gravel Foundation with treated stringers

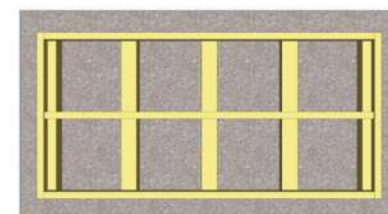

Completed Foundation

Gravel with 4x4 Pressure Treated Stringers:

- Excavate at least 6" deep, and 6" wider than floor frame on each side.
- 0.6 Cubic Yards of gravel required, approximately 6 wheelbarrows.
- 5 - 4x4 Pressure Treated Stringers 44 3/4" long required.
- Evenly spaced, with one at each end of floor frame.

Saves money on materials, easy to level and work with.

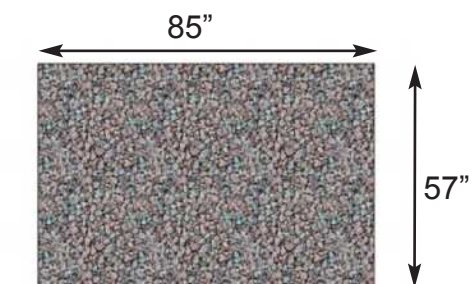

Gravel Foundation



Gravel Foundation with Patio Pavers

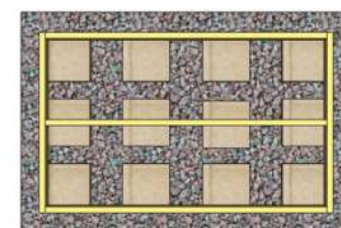

Completed Foundation

Gravel with Patio Paver Stones:

- Excavate at least 6" deep, and 6" wider than floor frame on each side.
- 0.6 Cubic Yards of gravel required, approximately 6 wheelbarrows.
- 12 patio pavers (8" x 8" or larger).
- Center patio paver stones underneath floor runners and underneath seams in floor joists.

Patio paver stones are widely available from most landscape stores.

Thank you for purchasing our 4x6 Space Master with Cedar Roof. Please take the time to identify all the parts prior to assembly.

Parts List	Steps	D. - Trim / Misc. Section Cont.	Steps
<p>A. - Floor Section</p> <p>Floors 1 - Floor Section - 45" x 73" 1 - Mid Floor Joist - 1 1/2" x 2 1/2" x 70"</p>	1	<p>Outer Wall Trim and Fascia 4 - Roof Nailing Strips - 3/4" x 1" x 24 1/2" 2 - Vertical Door Frame Trims - 1" x 2 5/8" x 78 1/2" 2 - Rear Wall Corner Trims - 1/2" x 3 1/2" x 67 7/8" 4 - Side Wall Corner Trims - 1/2" x 3 1/2" x 76" 2 - Side Wall Trim - 1/2" x 2 1/2" x 73 1/2" 2 - Upper Horizontal Side Wall Trim - 1/2" x 2 1/2" x 66 5/8" 1 - Rear Horizontal Gable Trim - 1/2" x 3" x 42 1/4" 1 - Rear Wall Center Trim - 1/2" x 2 1/2" x 74 3/4" 4 - Front/Rear Fascia - 3/4" x 3 1/2" x 27 1/4" - Angle Cut Ends 4 - Side Fascia - 3/4" x 3 1/2" x 39 5/8" 2 - Pentagon Detail Plates - 1/2" x 5" x 8" 2 - Side Fascia Detail Plates - 1/2" x 3 1/2" x 8"</p>	43 - 53
<p>B. - Wall Section</p> <p>Main Wall Panels 2 - Rear Walls - 22 1/2" x 72 3/4" 4 - Side Walls - 35" x 72 3/4" 4 - Top Wall Plates - 1 1/2" x 1 1/2" x 35" 2 - Top Wall Plates - 1 1/2" x 1 1/2" x 22 1/2"</p> <p>Header/Gables 2 - Door Jambes - 1 1/2" x 1 1/2" x 72 3/4" 2 - Side Top Wall Plates - 1 1/2" x 1 1/2" x 71 1/2" 1 - Rear Top Wall Plate - 1 1/2" x 1 1/2" x 42" 1 - Door Header - 1 1/2" x 1 1/2" x 45" 2 - Side Wall Top Plates - 3/4" x 1 1/2" x 73" - Angle Cut 2 - Front/Rear Gables - 11 3/4" x 42"</p>	2 - 8 9 - 15	<p>Door System 1 - Door Threshold (Bevel) - 1/2" x 4 1/2" x 42" 2 - Left/Right Doors - 20 5/8" x 72" 1 - Door Flange - 1/2" x 2 1/2" x 72" 4 - Interior Vertical Door Stops - 3/4" x 3/4" x 29 7/8" 1 - Top Interior Door Stop - 3/4" x 1 1/2" x 42" 1 - Interior Door Flange - 3/4" x 2 1/2" x 71 1/2"</p> <p>Miscellaneous 4 - Storage Shelf Supports - 3/4" x 2 1/2" x 35" 2 - Storage Shelves - 11 1/2" x 41 7/8" 1 - Front Horizontal Gable Trim - 1/2" x 2 1/2" x 42" 1 - Metal Drip Edge - 41 7/8"</p> <p>** Plus 2 Cedar Shingle Shims - discard after shimming doors</p>	54 - 66 67 - 69
<p>C. - Rafters and Roof Section</p> <p>Roof 6 - Metal Roof Panels - 28 3/8" x 41" 8 - Rafters - 1 1/2" x 2 1/2" x 26 1/2" 4 - Soffits - 3/4" x 3 1/2" x 36 1/2" 2 - Roof Ridge Boards - 3/4" x 3 1/2" x 73" 6 - Battens - 1" x 3 1/2" x 78" 8 - Batten Spacers - 5" x 16" 2 - Roof Ridge Cap Long - 5" x 16"</p>	16 - 35	<p>Note: We recommend you drill a 1/8" pilot hole for each screw to avoid splitting wood. The hole depth should be equal to 3/4 the length of screw.</p>	
<p>D. - Trim / Misc. Section</p> <p>Lower Skirting 1 - Front Skirting - 1/2" x 2 1/2" x 42" 4 - Side Skirting - 1/2" x 2 1/2" x 35 3/4" 2 - Rear Skirting - 1/2" x 2 1/2" x 21 3/4"</p> <p>Filler Trim 8 - Front/Rear Filler Trims - 5/8" x 1 1/2" x 33" 2 - Front/Rear Horizontal Filler Strip - 5/8" x 1 1/2" x 42"</p>	38 39 - 42		

Note: Trim and Skirting pieces are graded with the best face being rough sawn. Rough sawn cedar is much easier to paint and stain.

4x6 SPACE MASTER - DOUBLE DOORS & CEDAR ROOF

Hardware Kit (Provide)

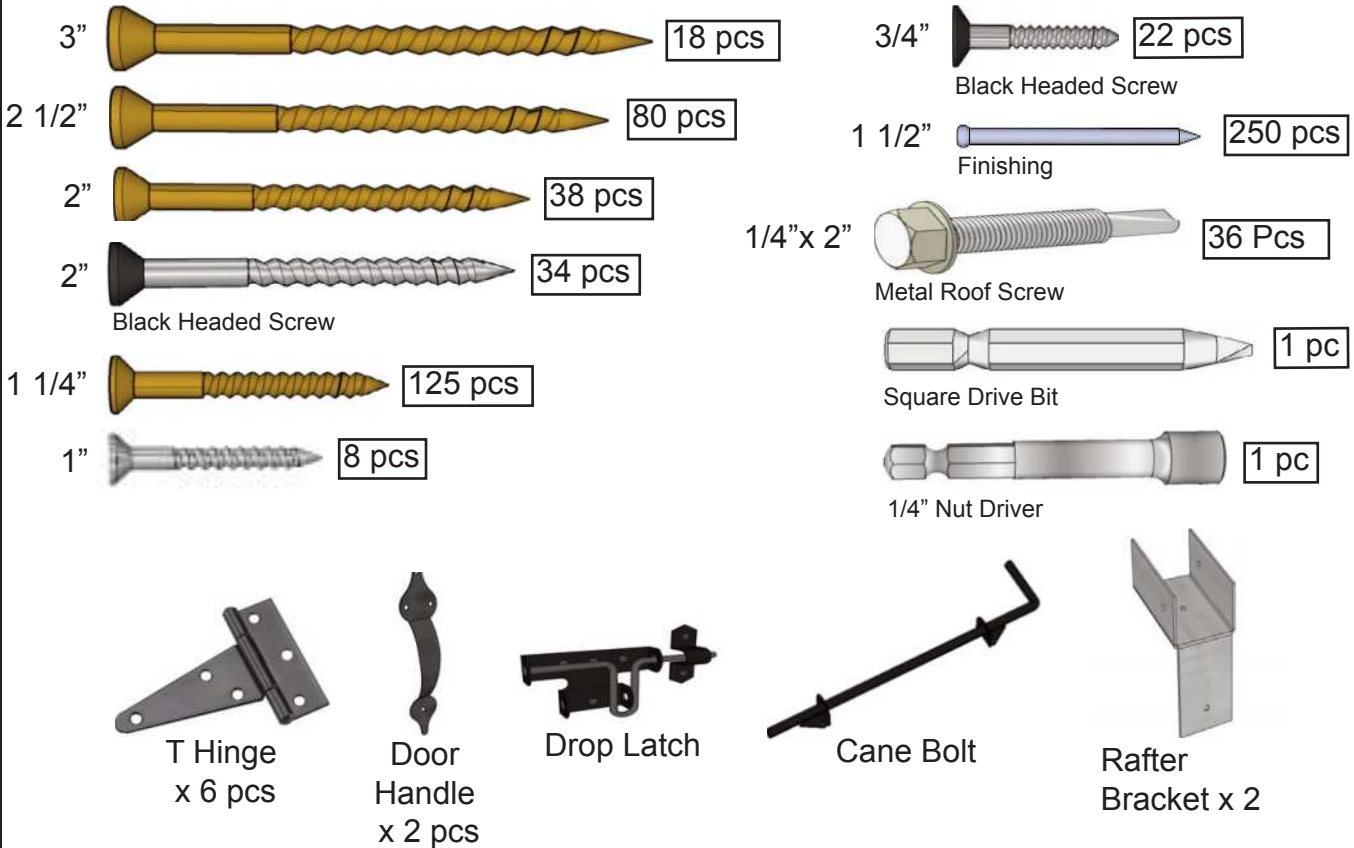

Tools Required (Not Provided)



Safety Equipment Required (Not Provided)



Regular Maintenance & Tips to prolong the life of your shed.

Before/During Assembly:

- 1.) Paint each face and edge of your plywood floor with a latex exterior paint.
- 2.) Caulk wall seams if gaps appear.
- 3.) Caulk around window framing.
- 4.) Caulk perimeter between floor plywood and bottom wall plate.
- 5.) Caulk channels in lap siding at the top of your door above the trim, just a drop in each channel.
- 6.) Caulk edge of door threshold.
- 7.) Optional: Install a Sill Gasket between floor runners and foundation.
- 8.) Optional: Install an 8" strip of roofing paper below Cedar Ridge Caps for Cedar Roof Sheds.

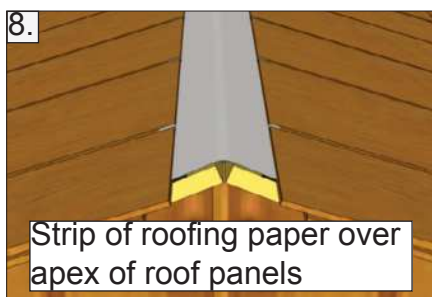
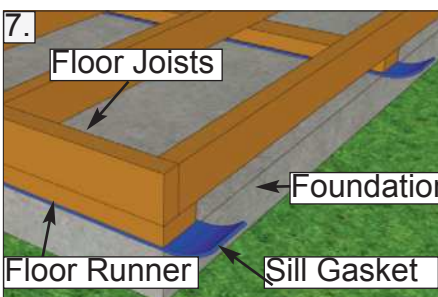
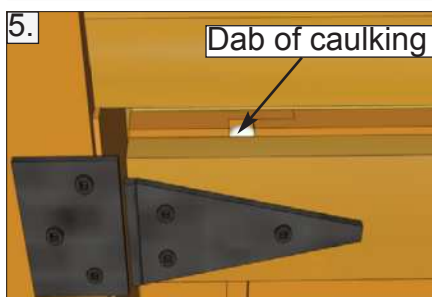
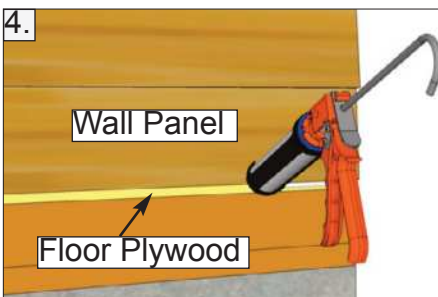
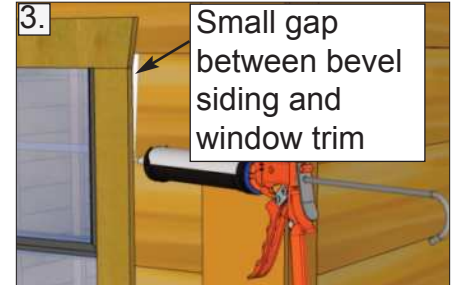
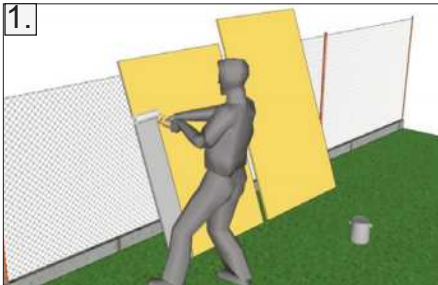

Routine Maintenance:

- Routinely check all fasteners are tight (ex. Door Hinges, Nails)
- Brush off dirt from walls.
- Brush off snow from roof regularly.
- Routinely remove needles and leaves from cedar roof.

Painting/Staining

- Your cedar shed, if left untreated, will weather to a silvery grey colour.
- Painting or staining your structure is highly recommended and will prolong the life of your shed.
- You do not need to wait to paint or stain your shed, the wood in your kit has been dried and can be stained or painted immediately.
- Consult your local paint store for the best paint or stain for cedar.
- Optional: stain the inside of your shed. (Note: this will remove the fresh cedar smell.)

A. Floor Section

Exploded view of all parts necessary to complete the Wall Section. Identify all parts prior to starting.

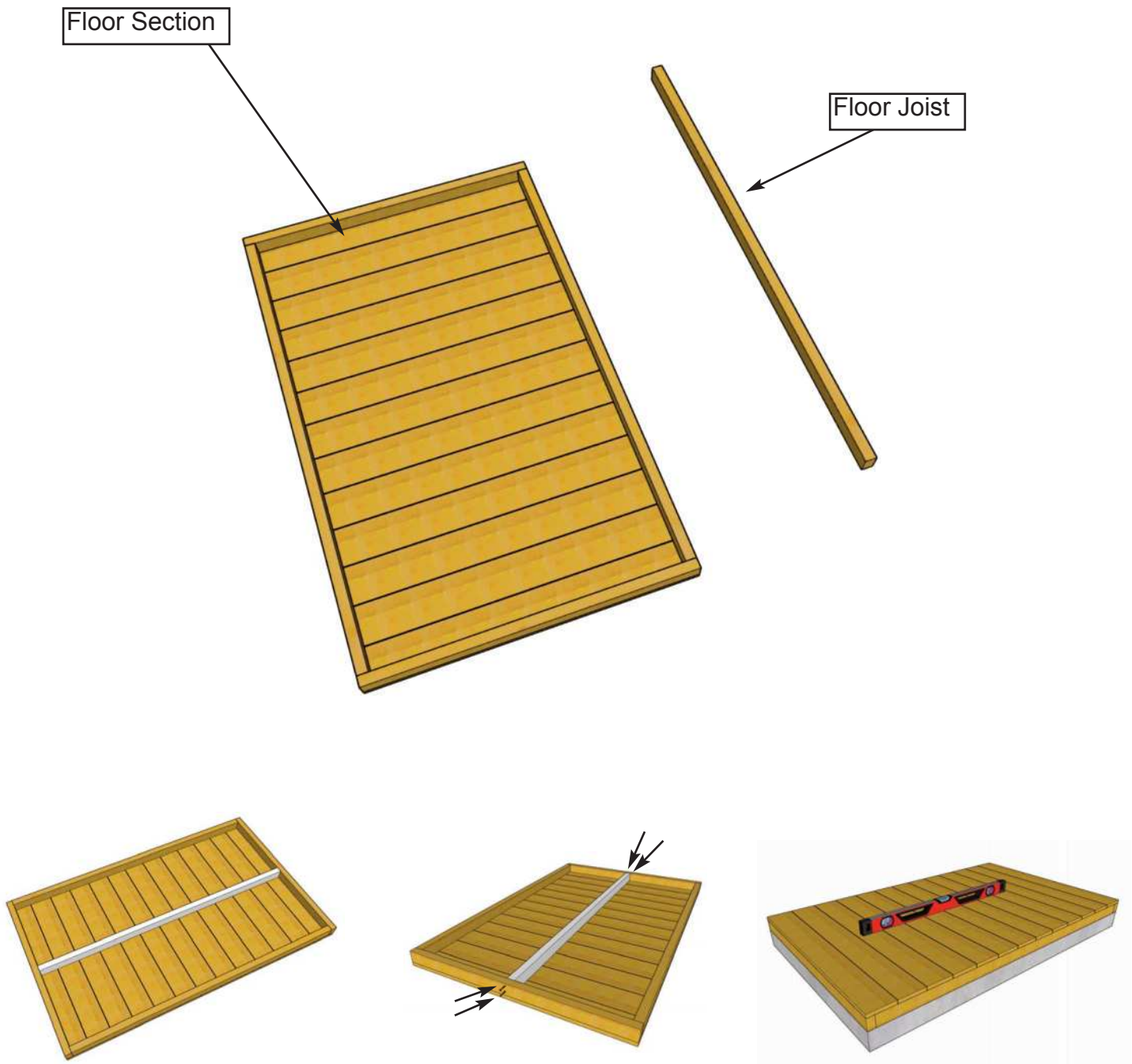

1. Locate **Floor Joist** and position at center of **Floor Section** and flush with framing as illustrated above. Attach with **2 - 2 1/2" Brown Screws** per end. Flip over and lay Floor Section on a level foundation only. Patio Stones or a Concrete Slab both make excellent foundations. (See Page 3 for more information on foundations). Use a level to confirm and shim Floor Joist as required.

<p><u>Parts</u> Floor Joist (1 1/2" x 2 1/2" x 70") x 1 Floor Section (45" x 73") x 1</p>
<p><u>Hardware</u> 2 1/2" Brown Screws x 4 total</p>

B. Wall Section

Exploded view of all parts necessary to complete the Wall Section. Identify all parts prior to starting.

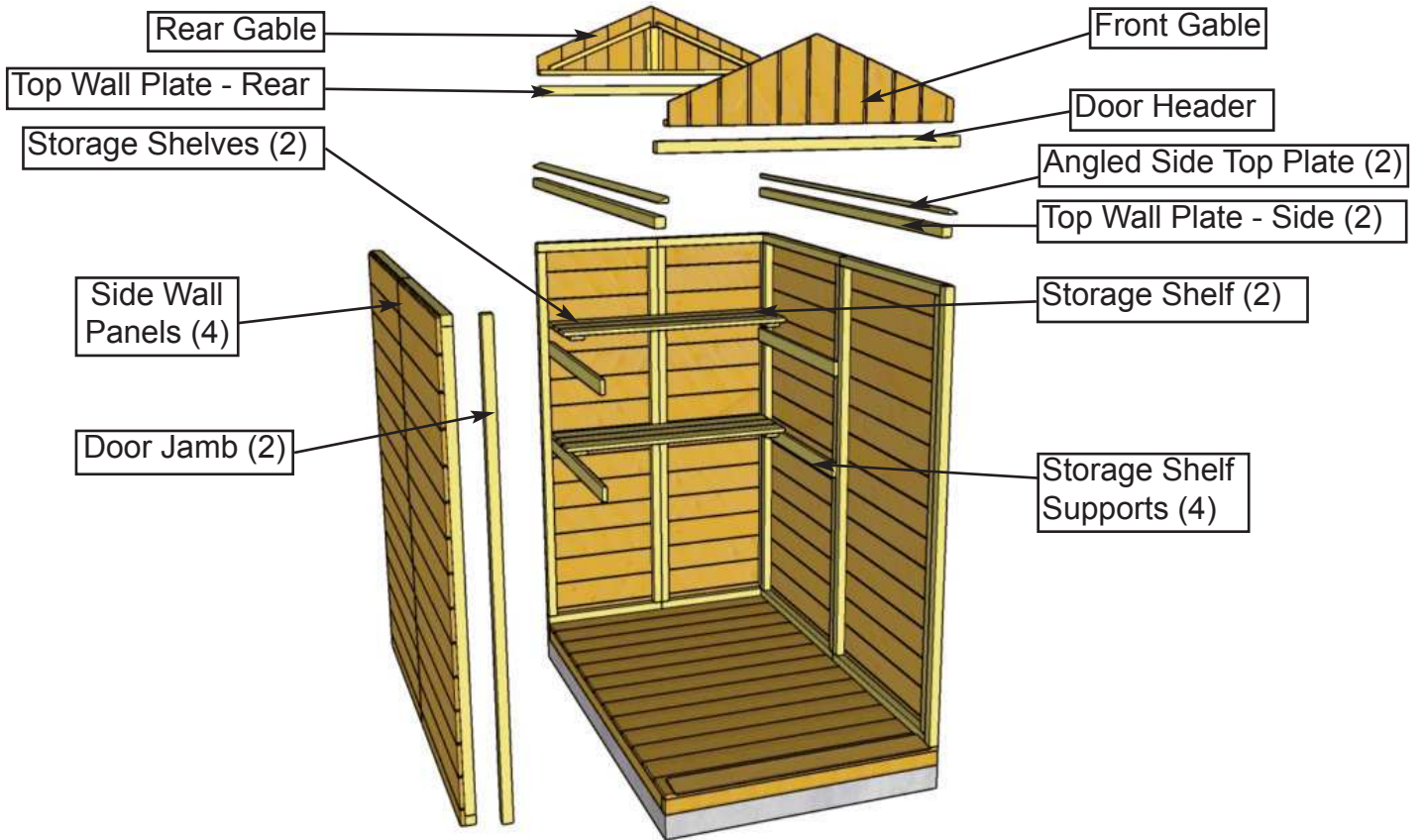

Due to packaging constraints, top wall plates must be attached prior to erecting walls.

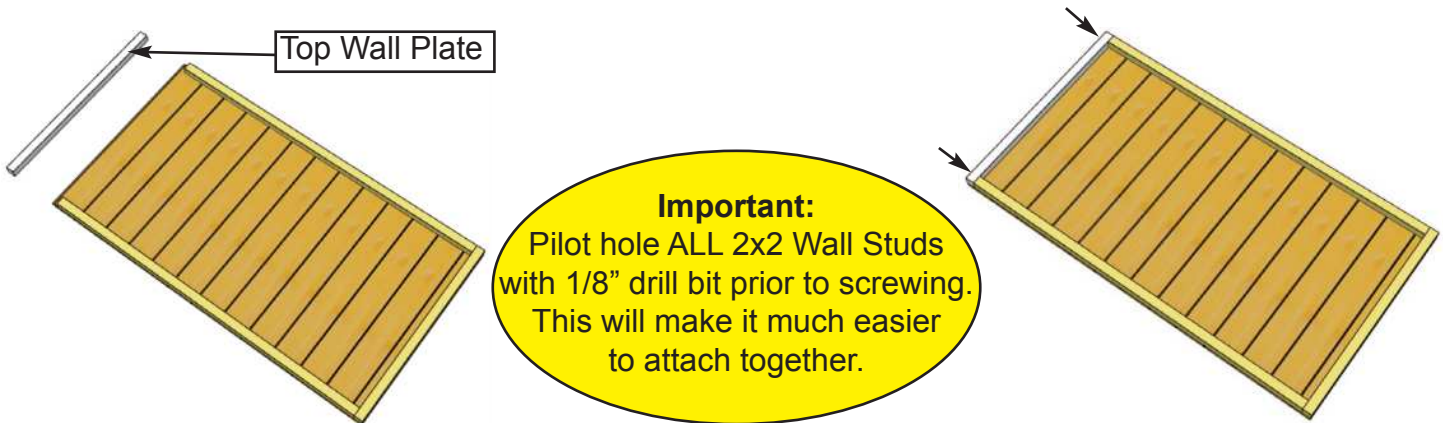

2. For each **Rear and Side Wall Panel**, carefully lay Panel face down. Position and attach a **Top Wall Plate** to top of wall studs of each Wall Panel with **2 - 2 1/2" Brown Screws**. Position so Plates are flush with framing.

Parts	Parts	Hardware
Rear Wall Panels (22 1/2" x 72 3/4") x 2 Top Wall Plates (1 1/2" x 1 1/2" x 22 1/2") x 2	Side Wall Panels (35" x 72 3/4") x 4 Top Wall Plates (1 1/2" x 1 1/2" x 35") x 4	2 1/2" Brown Screws x 12 total

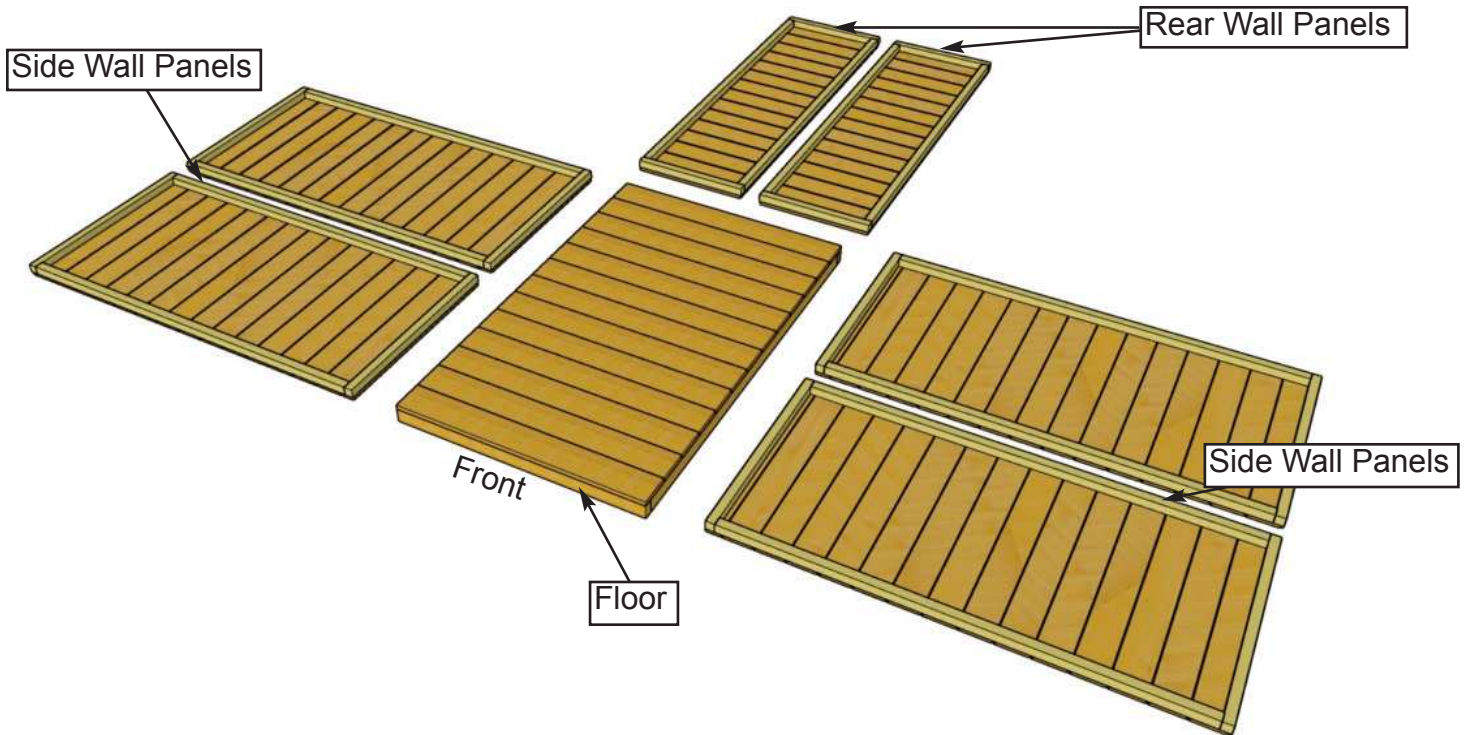

3. With Wall Plates properly attached, orientate completed Walls around the Floor. Be sure to leave room to work.

Wall Framing flush with Floor framing. Siding overhangs floor.

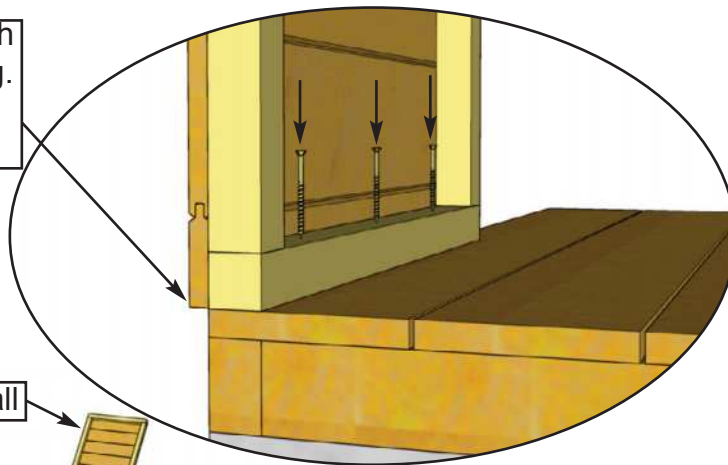

Before completely attaching Walls to Floor (**Step 15**), check to make sure Door opening is 42" wide. See **Step 12** for illustration.

Rear Left Wall

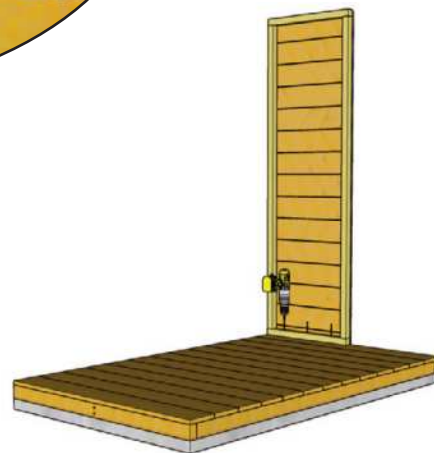
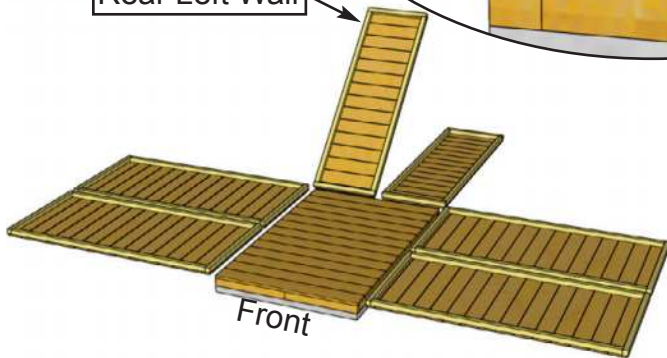

4. Starting with **Rear Left Wall**, lift up and position so framing is flush with Floor at the rear of shed. Make sure Wall frame is flush with outside of Floor on the side. When Wall is positioned correctly, secure Bottom Wall Plate to Floor with **3 - 2 1/2" Brown Screws**.

Hardware (Steps 4 - 8)
2 1/2" Brown Screws
 x 3 total
3" Brown Screws
 x 15 total

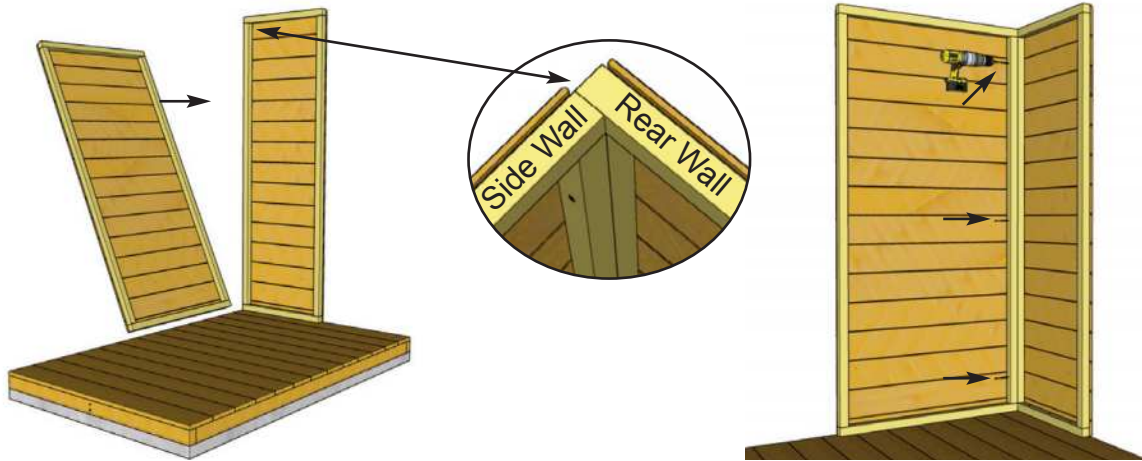

5. With your helper holding the Rear Wall Panel, position a **Side Wall Panel** in rear corner. **Important: Align Wall Framing Flush with Floor Framing.** Fasten side wall to rear wall with **3 - 3" Brown Screws**.

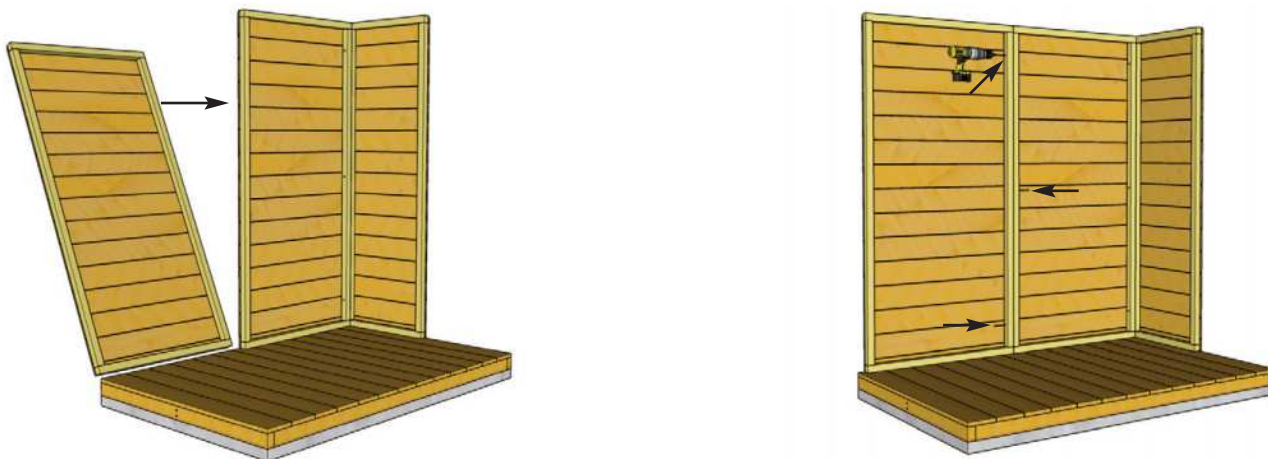

6. Position second Side Wall flush with previous. Fasten to previous wall with **3 - 3" Brown Screws** as per **Step 5**.

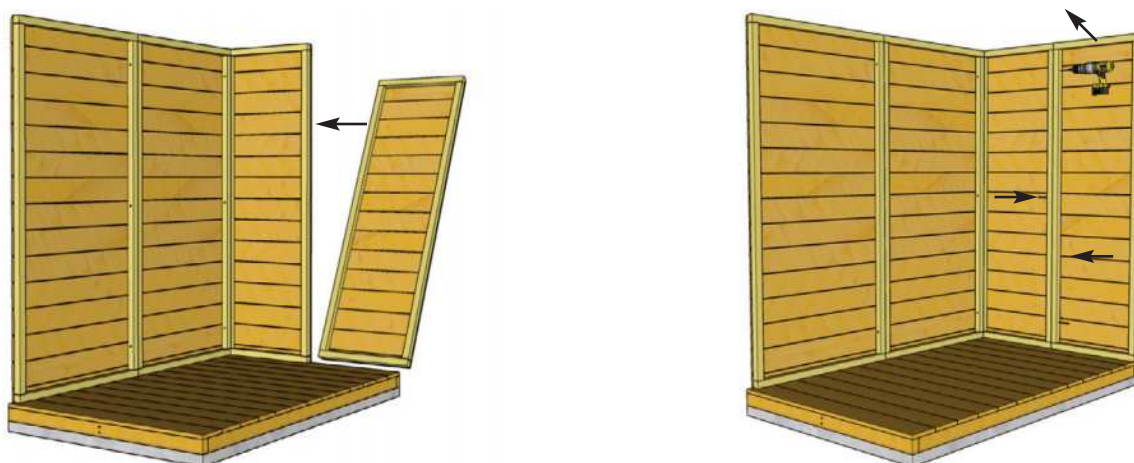

7. Locate second Rear Wall and position beside the first one. Fasten Rear Walls together with **3 - 3" Brown Screws**.

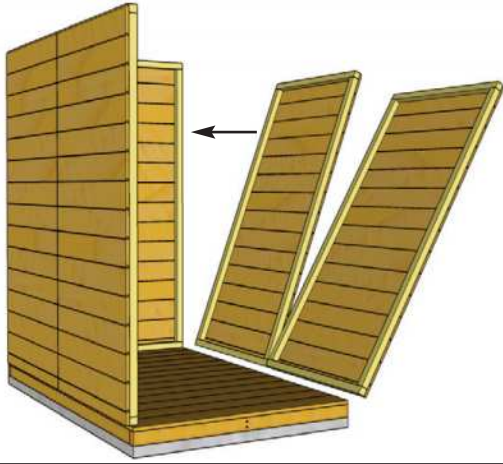

8. Locate remaining **Side Walls**, position and fasten as per **Steps 5 - 6** with **3 - 3" Brown Screws** per wall.



9. With all walls fastened together, locate **Door Jambs**. Position Door Jambs flush with front side walls. Attach Door Jambs to wall framing with **3 - 2 1/2" screws** per Door Jamb

<p><u>Parts</u> Door Jambs (1 1/2" x 1 1/2" x 72 3/4") x 2</p>	<p><u>Hardware</u> 2 1/2" Brown Screws x 6 total</p>
---	---

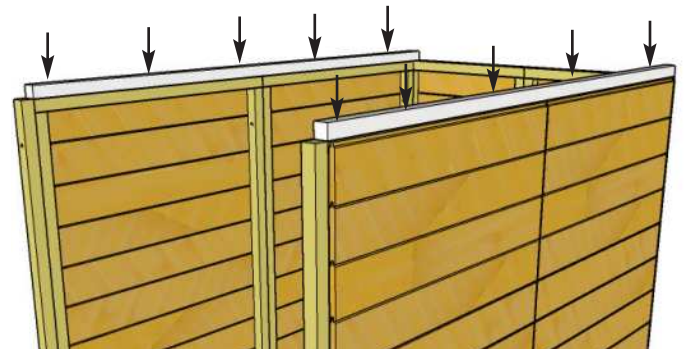
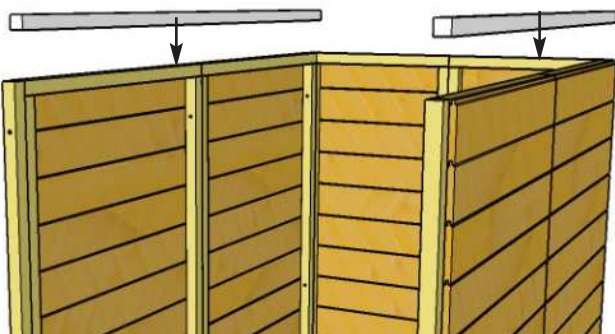

10. Locate **Side Top Wall Plates**. Screw Side Top Wall Plates down with **5 - 2 1/2" screws** per piece onto Side Wall framing.

<p><u>Parts</u> Side Top Wall Plates (1 1/2" x 1 1/2" x 71 1/2") x 2</p>	<p><u>Hardware</u> 2 1/2" Brown Screws x 10 total</p>
---	--

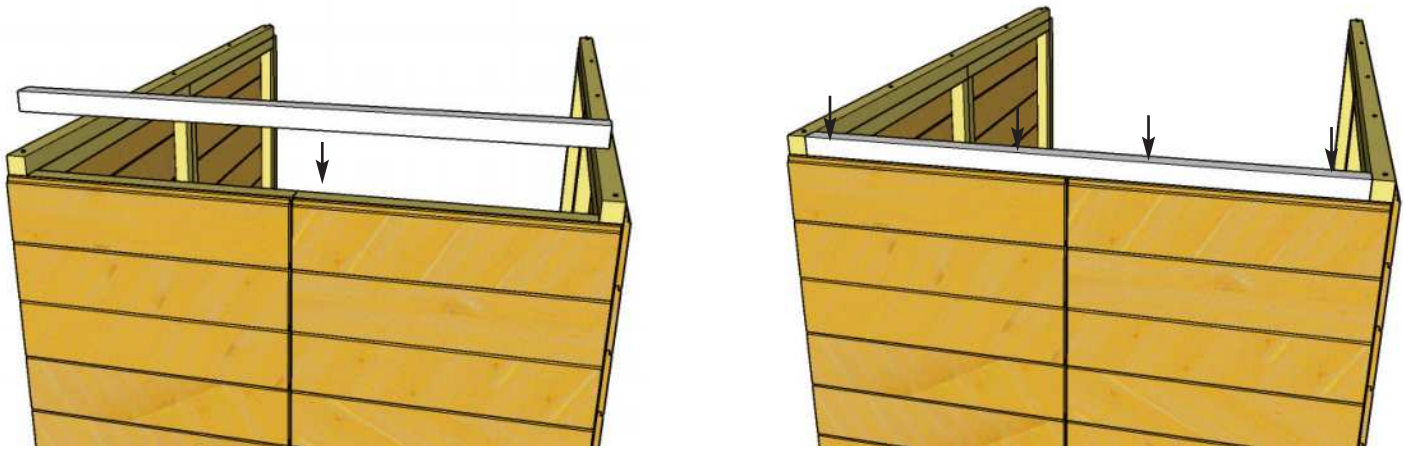

11. Position **Rear Top Wall Plate** on top of rear Walls. Rear Top Plate should fit between Side Top Wall Plates. Fasten Rear Top Wall Plate to shed with **4 - 2 1/2" Brown Screws** into Rear Wall framing.

<u>Parts</u> Rear Top Wall Plate (1 1/2" x 1 1/2" x 42")	<u>Hardware</u> 2 1/2" Brown Screws x 4 total
---	--

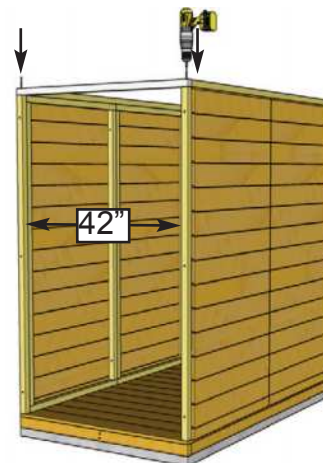

12. Position **Door Header** on top of Door Jambs. Door Header should be flush with top wall framing. Fasten Door Header to shed with **2 - 2 1/2" screws** into Door Jambs. Confirm doorway opening.

<u>Parts</u> Door Header (1 1/2" x 1 1/2" x 45") x 1	<u>Hardware</u> 2 1/2" Brown Screws x 2 total
---	--

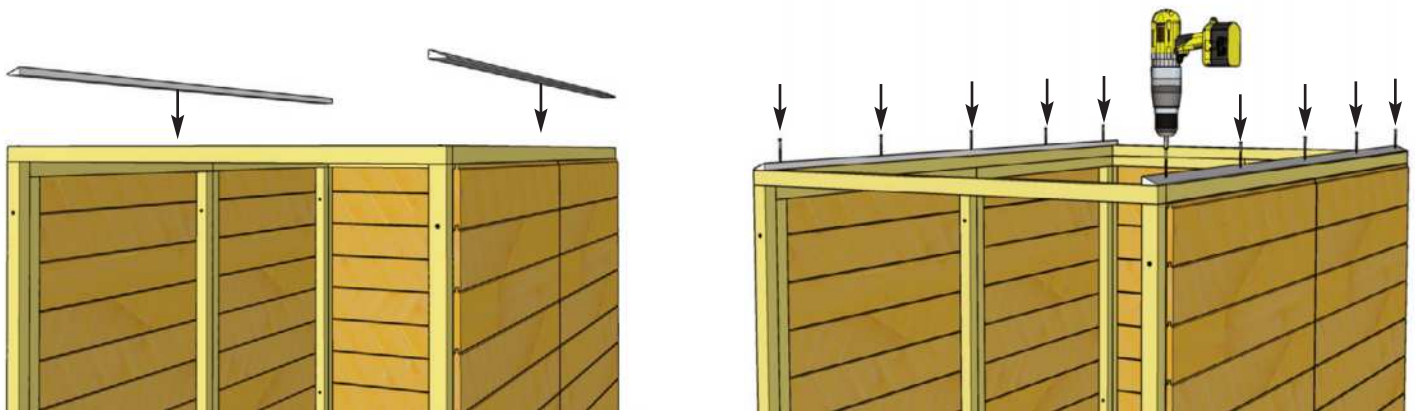

13. Locate **Side Wall Top Plates**. These Top Plates are angle cut at 22.5°. Screw Top Plates down with **5 - 2 1/2"** screws per Top Plate.

<u>Parts</u> Side Wall Top Plates (3/4" x 1 1/2" x 73") x 2	<u>Hardware</u> 2 1/2" Brown Screws x 10 total
--	---

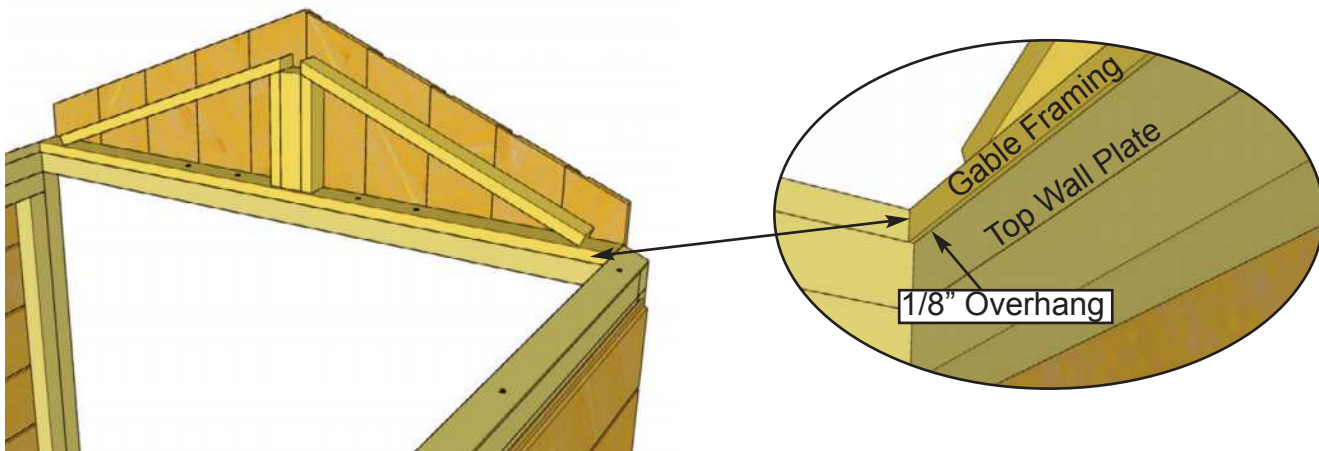
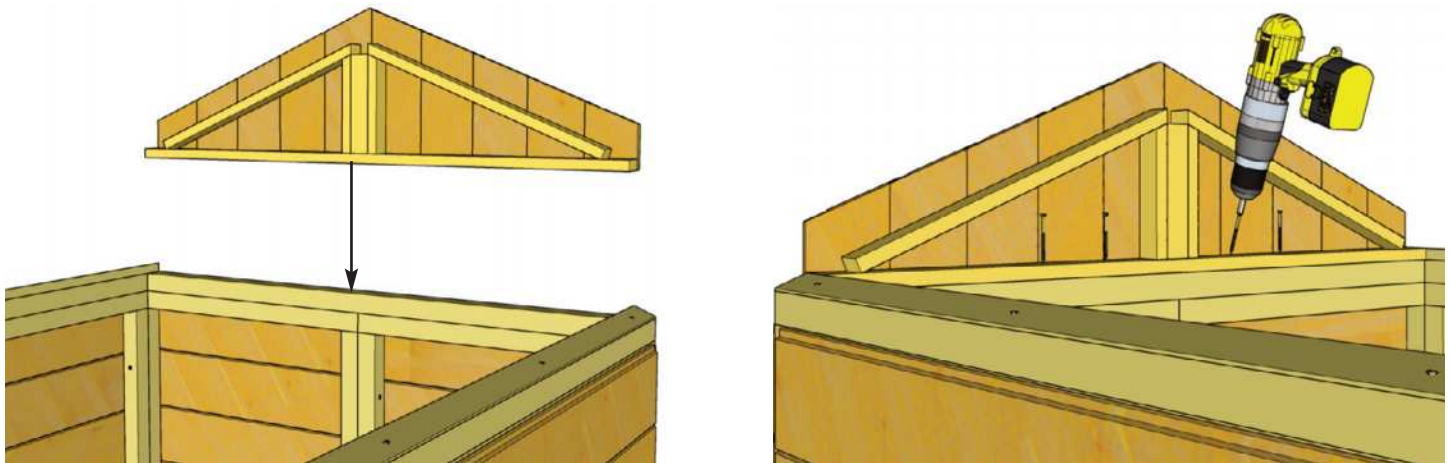

14. Locate both **Gables**. Position one Gable on top of Rear Walls between Side Wall Top Plates. Fasten Gable down with **4 - 1 1/4" Brown Screws**. **Important:** Gable framing will overhang Rear Top Wall Plate and Door Header by 1/8" on both sides.

<u>Parts</u> Gables (11 3/4" x 42") x 2	<u>Hardware</u> 1 1/4" Brown Screws x 8 total
--	--

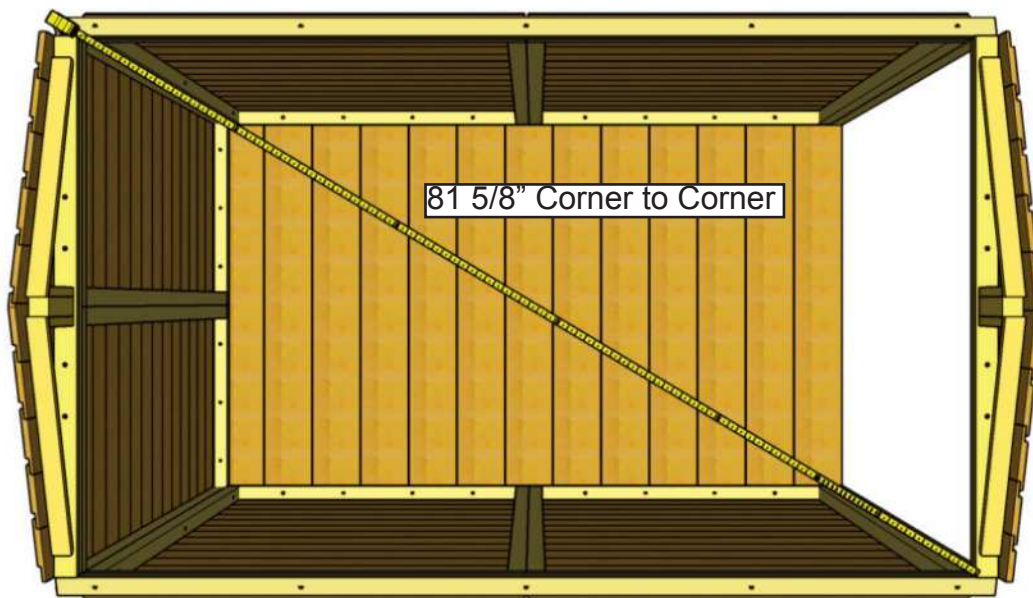
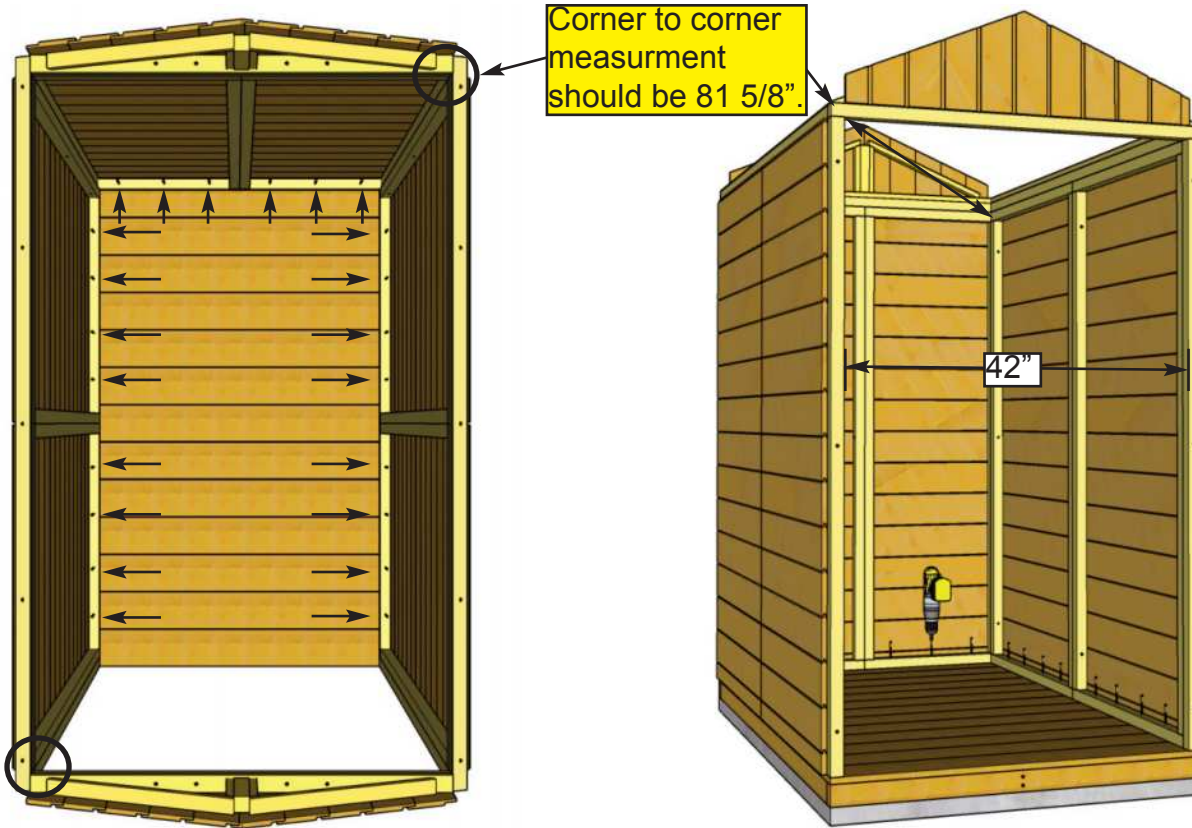

15. With Gables installed re confirm doorway opening is 42". Check interior corner to corner measurements are 81 5/8" across diagonally. With doorway measurement confirmed, begin to fasten wall panels down to floor with 2 1/2" screws. Use **3 - 2 1/2" screws** per Rear Wall and **4 - 2 1/2" screws** per Side Wall. Screw through Bottom Wall Plate into floor. Note: Rear Left Wall already fastened down in Step 4.

Hardware
2 1/2" Brown Screws
 x 19 total

C. Rafter & Roof Section

Exploded view of all parts necessary to complete the Rafter and Roof Section. Identify all parts prior to starting.

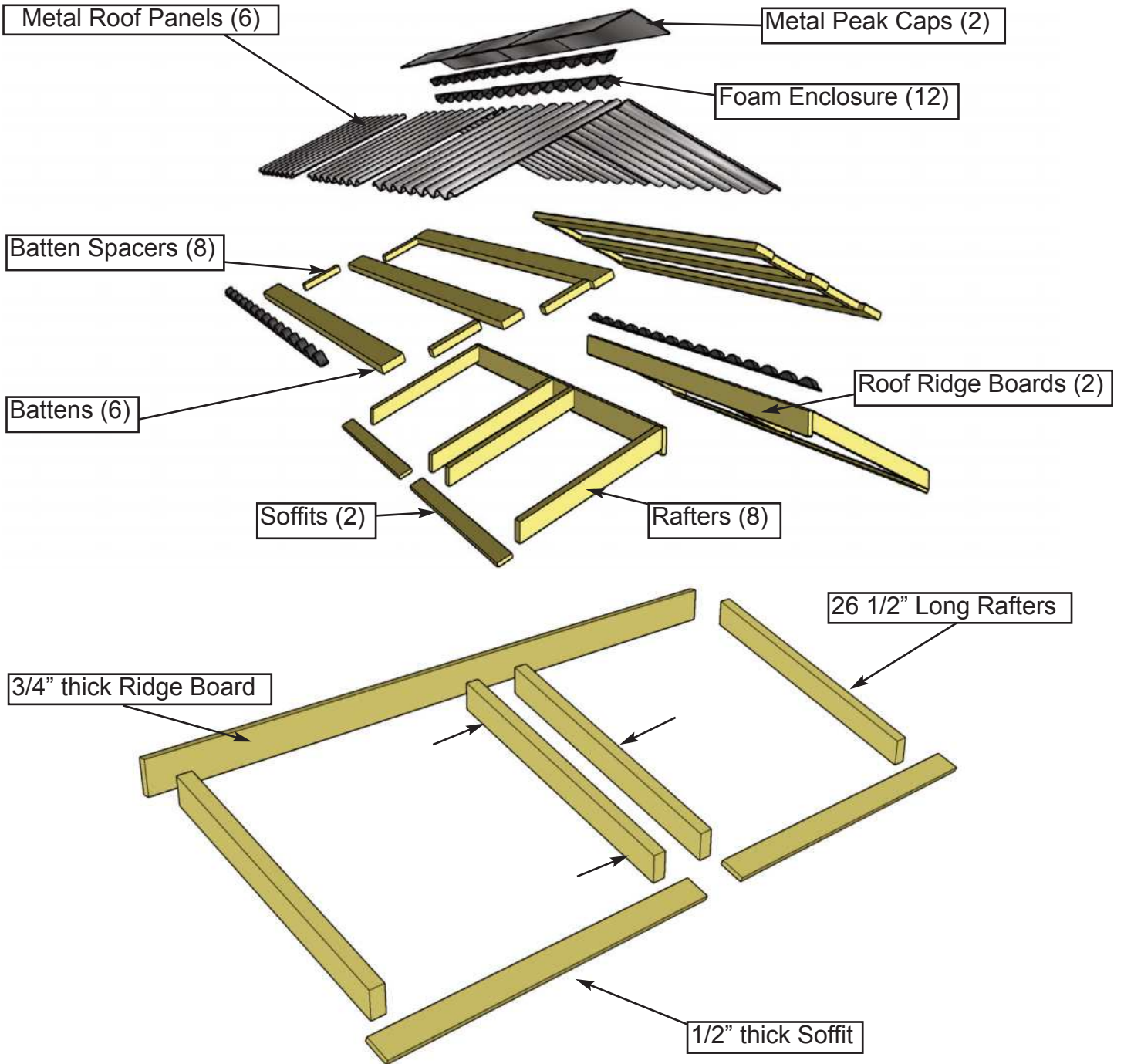

16. Locate 8 Rafters, 2 Ridge Boards, and 4 Soffits. Evenly space out Rafters and lay out as illustrated, on a flat level surface. Screw doubled up Rafters together with 3 - 2 1/2" Brown Screws.

<p><u>Parts</u></p> <p>Ridge Boards (3/4" x 3 1/2" x 73") x 2</p> <p>Rafters (1 1/2" x 2 1/2" x 26 1/2") x 8</p>	<p>Soffits (3/4" x 3 1/2" x 36 1/2") x 4</p> <p><u>Hardware</u> 2 1/2" Brown Screws x 6 total</p>
--	---

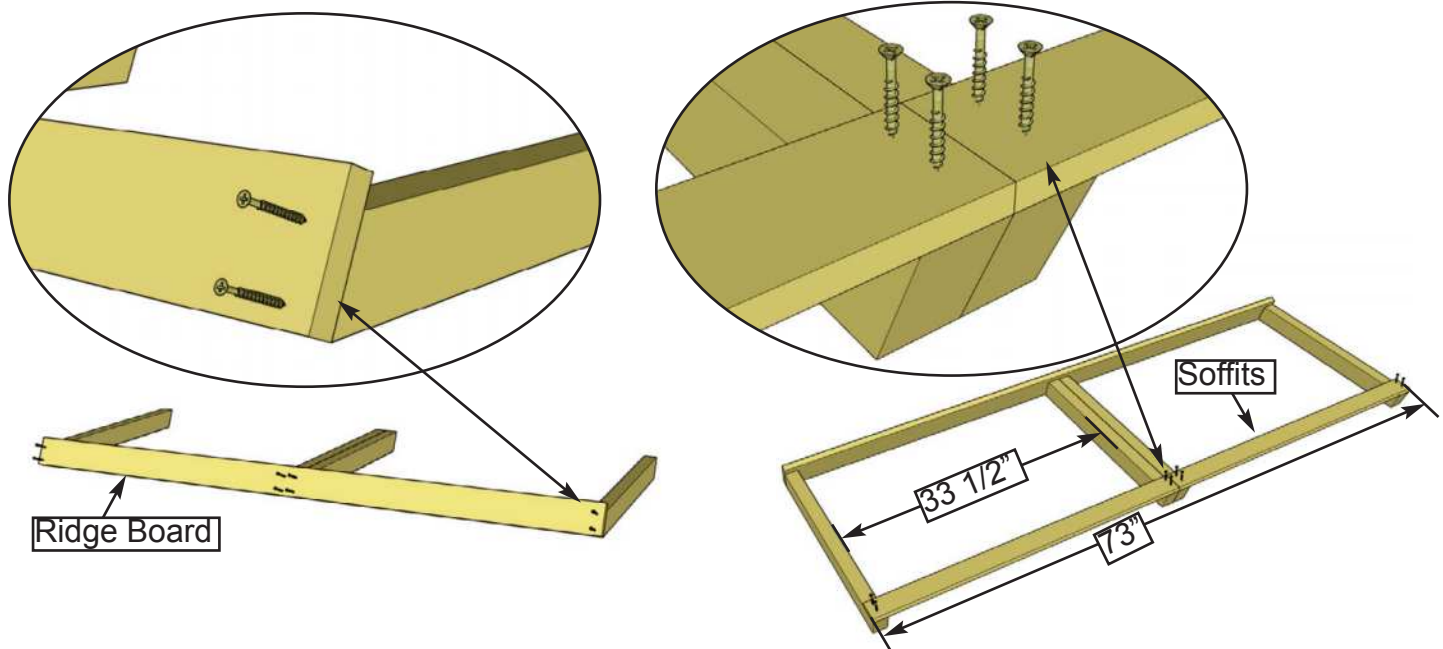

Important: Pilot Hole Ridge Board and Soffit prior to screwing to prevent splitting!

17. Attach **Ridge Board** to ends of both outside **Rafters** with **2 - 2" Brown Screws** per end. Drill a 1/8" pilot holes in Ridge Board to prevent splitting. Rafters should be 33 1/2" apart. Position **Soffits** on underside of Rafters on opposite end from Ridge Board. Screw Soffits into Rafters with **2 - 1 1/4" Brown Screws** per rafter.

Parts	
Ridge Board	(3/4" x 3 1/2" x 73") x 1
Rafters	(1 1/2" x 2 1/2" x 26 1/2") x 4
Soffits	(1/2" x 2 1/2" x 36 1/2") x 2

Hardware	
2" Brown Screws	x 8 total
1 1/4" Brown Screws	x 8 total

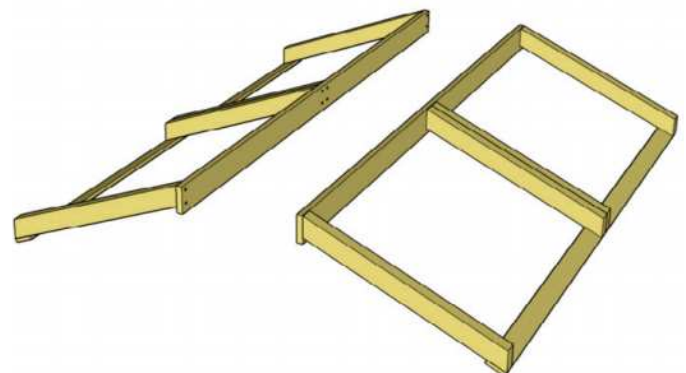
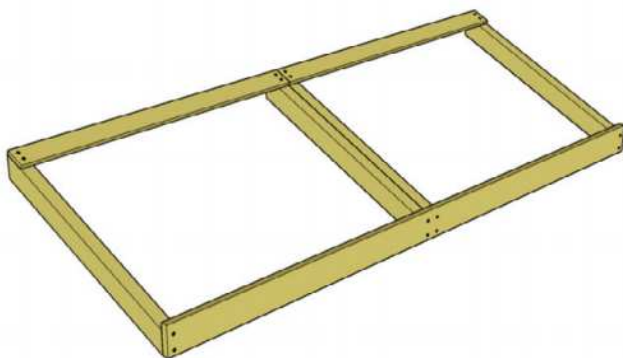

18. Repeat **Step 17** with remaining Rafter section components to assemble a second rafter section. Flip assembled Rafter Sections over once complete.

Hardware	
2" Brown Screws	x 8 total
1 1/4" Brown Screws	x 8 total

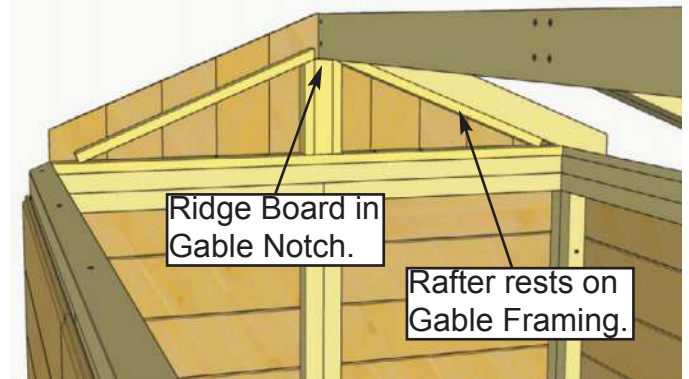

19. With a helper, lift one Rafter section onto shed. Slide the Rafter section up the Gables until the Ridge Board lands in the notch in the Gable.

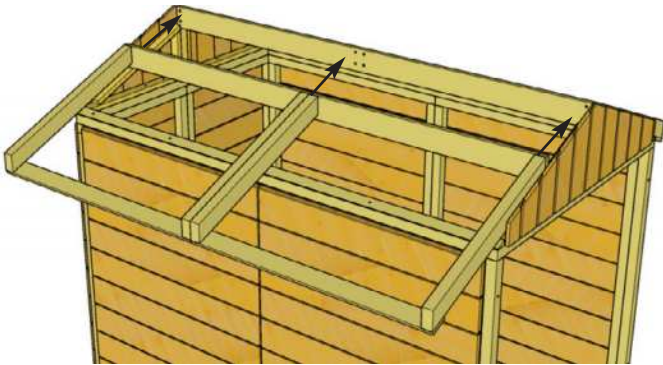

20. Repeat **Step 19** to lift second Rafter section onto shed.

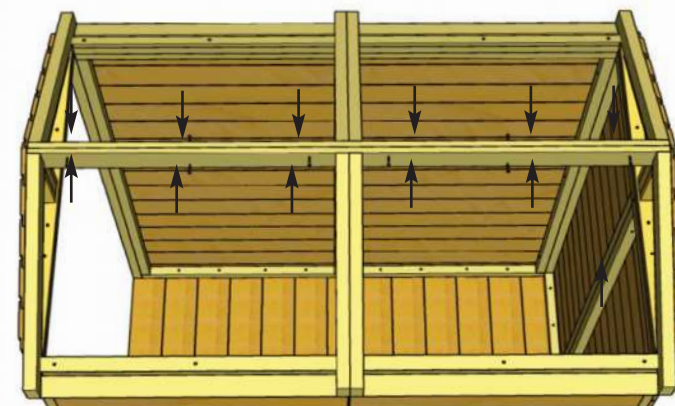

21. Align Ridge Boards together so the tops are flush at the peak. Screw Ridge Boards together with **6 - 1 1/4" screws** per side.

Hardware
1 1/4" Brown Screws
 x 12 total

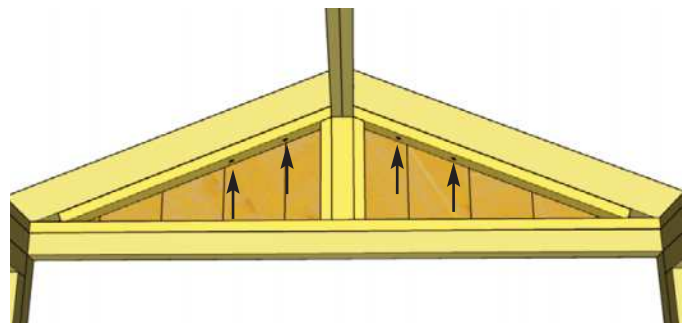

22. With Ridge Boards secured, fasten Gables to Rafters with **4 - 2" Brown Screws** per Gable.

Hardware
2" Brown Screws
 x 8 total

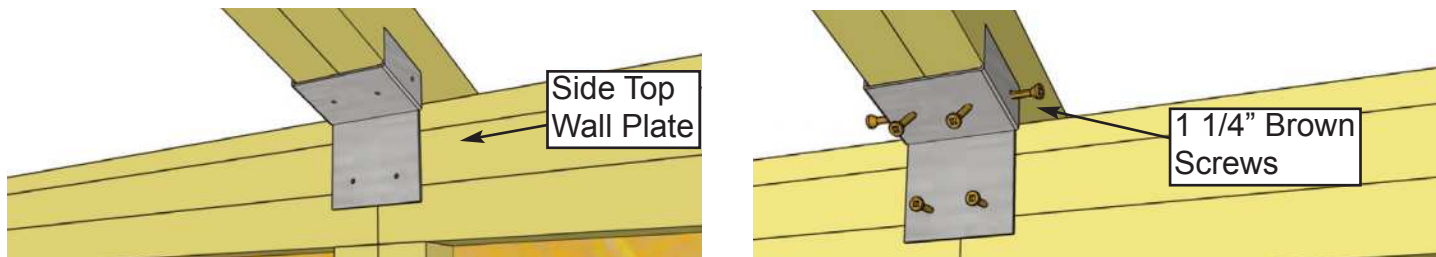

23. Attach middle Rafter to Side Top Wall Plate inside of shed using a Rafter Bracket and **6 - 1 1/4" Brown Screws**. Complete attachment of opposite middle Rafter.

Hardware

Rafter Bracket x 2 total
1 1/4" Brown Screws x 12 total

Important: Pre-drill Batten Spacers with 1/8" bit before fastening.

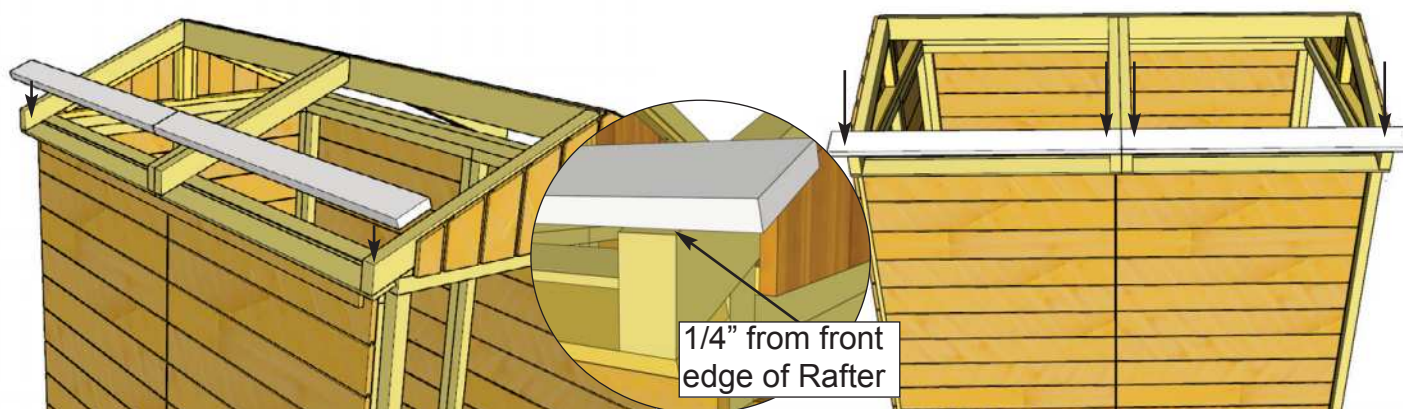

24. Locate first row of **Roof Battens** and place on Rafters 1/4" from front edge. Battens will overhang outside Rafters by approximately 2" on each side. Before attaching Batten to Rafters, pre-drill pilot hole with 1/8" bit to prevent Rafters from splitting. Secure each Batten board to Rafters with **2 - 1 1/4" Brown Screws**. Drill into center of Rafter.

Parts (Step 24 - 28)

Battens (1" x 3 1/2" x 39") x 12
Batten Spacers (3/4" x 1 1/2" x 12 3/8") x 8

Hardware (Step 24 - 28)

1 1/4" Brown Screws
 x 40 total

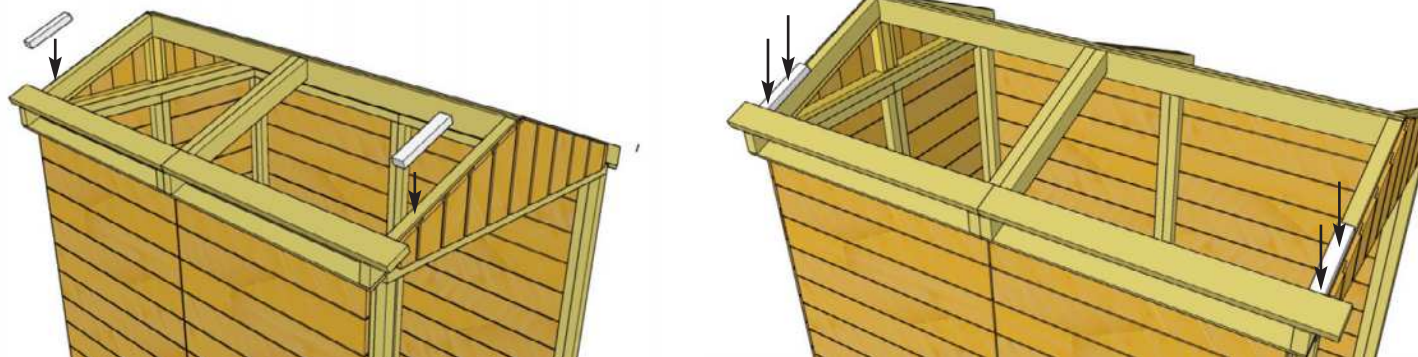

25. Place 2 **Batten Spacers** against attached Batten, lengthwise along outside Rafters. Ensure Batten Spacer is tight with Batten. Attach Batten Spacer to top of Rafter using **2 - 1 1/4" Brown Screws**. Batten Spacers are flush with Rafter edges.

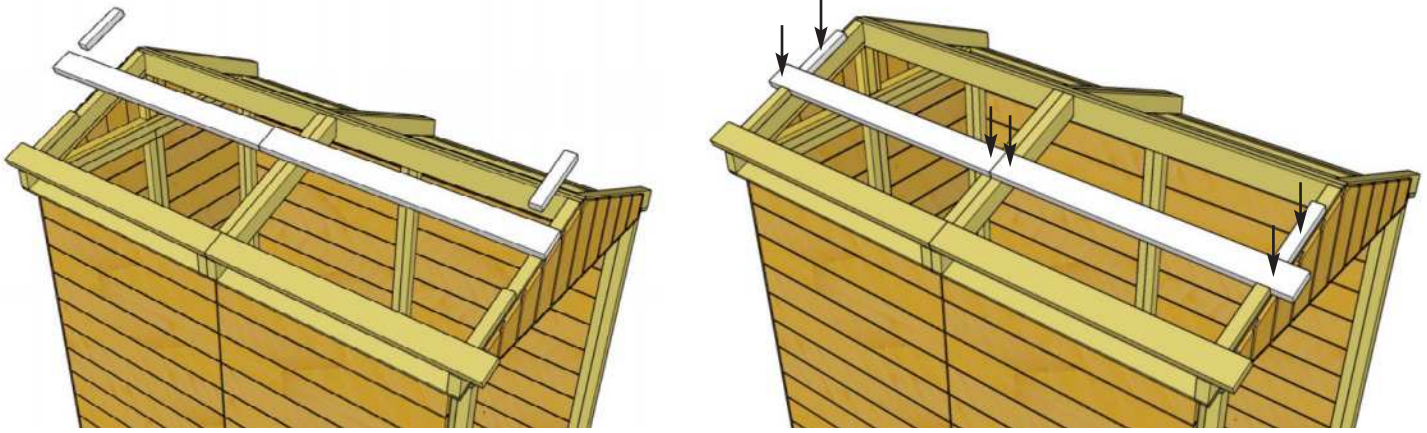

26. Locate another **Roof Batten** and position flush with previously attached Batten Spacers. Attach with **3 - 1 1/4" Brown Screws**, into Rafters. Attach a second row of **Batten Spacers** flush with the edge of this middle Batten row via the same method as **Step 25**.

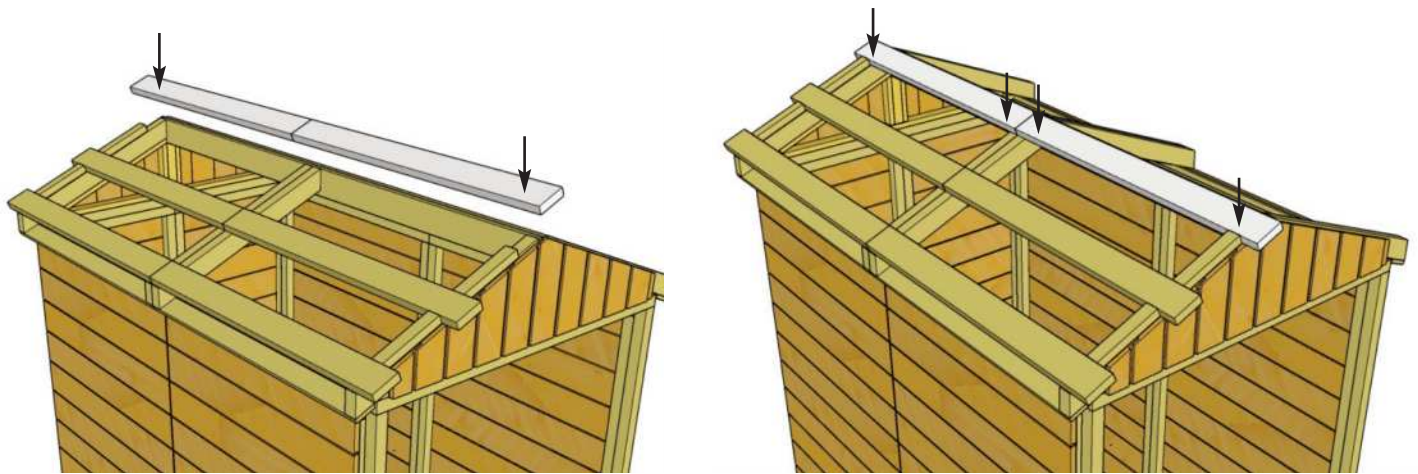

27. Locate the last **Roof Batten** and attach flush with previously attached **Batten Spacers** via the same method as **Step 26**, using a total of **3 - 1 1/4" Brown Screws**.

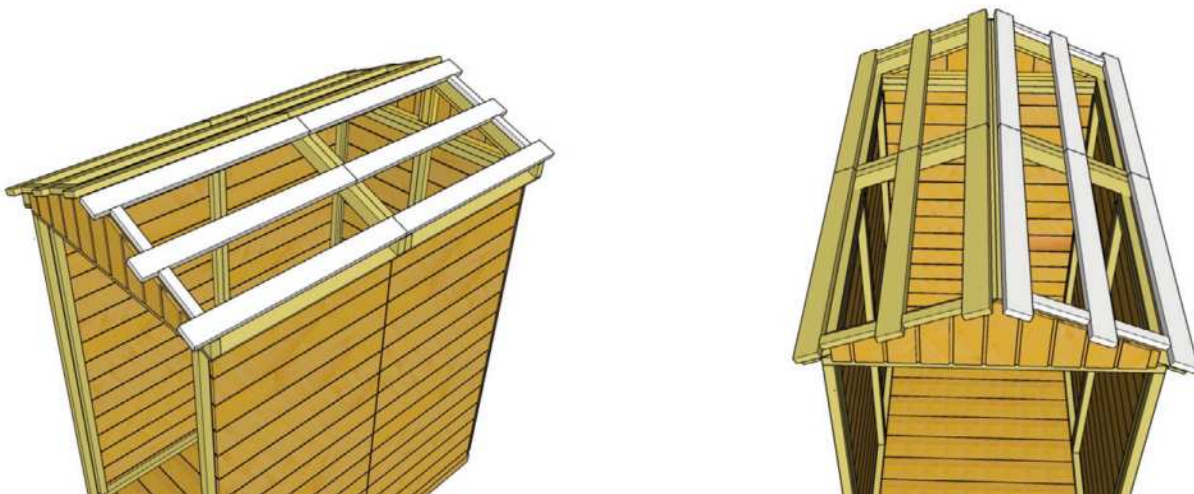

28. Complete opposite side of roof using remaining **Battens** and **Batten Spacers** by following **Steps 24 - 27**.

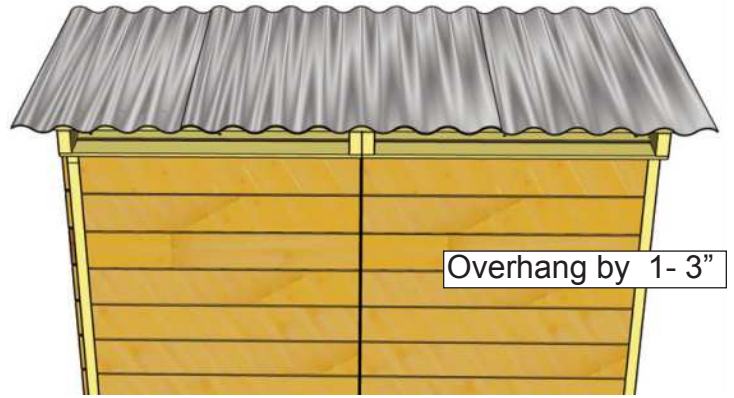

29. Starting on one side, locate three **Metal Roof Panels** and place on Battens. Overhang bottom of Metal Roof Panels approximately 2" past the edge of the Batten. Overhang the Metal Roof Panels past the Battens on the sides by approximately 1" - 3" depending on your personal preference. Panels will overlap.

Parts
Metal Roof Panel (43") x 3

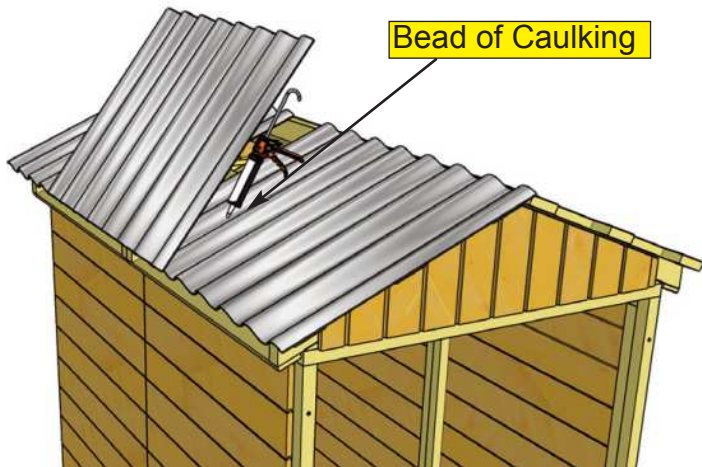

30. Once Metal Roof is spaced correctly from side-to-side and top-to-bottom, lift panels up and run a bead of caulking down the overlapping seams of each panel to seal the joints. You will likely need assistance from a helper in this step.

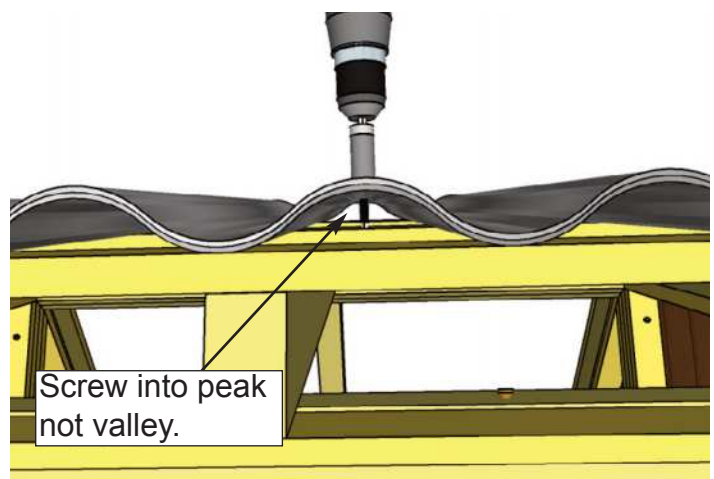

31. Using **6 - 2" Metal Roof Screws** and **1/4" Nut Driver** (included), secure Metal Roof Panels down to middle Batten row. Metal screw is self-tapping, do not overtighten. Screw through Roof Panels into center of Batten.

Parts
2" Metal Roof Screws x 6
1/4" Nut Driver x 1

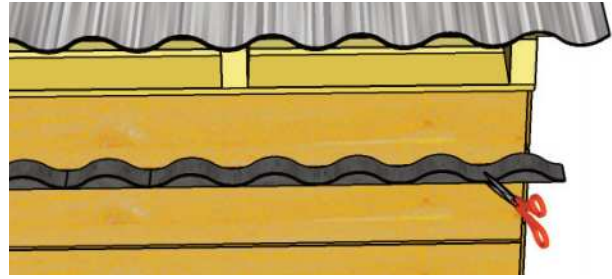
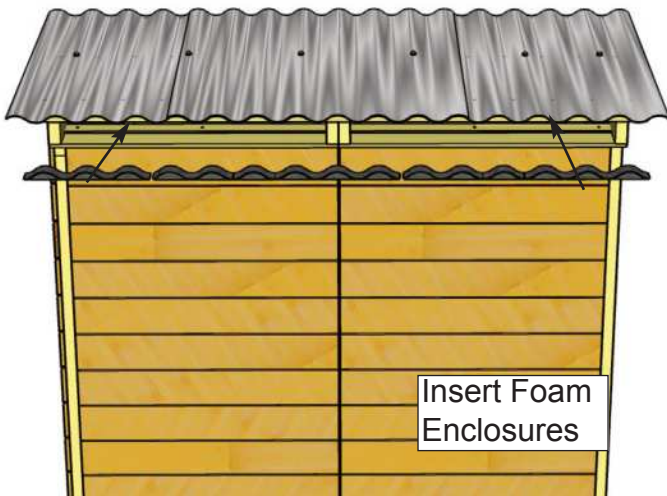

32. Insert **Foam Enclosures** between Metal Roof Panels and Battens at the side. Enclosures may need to be snipped down in length to fit. Enclosures will prevent moisture and unwanted bugs, etc. from entering your shed through here.

Parts
Foam Enclosures
 x 3



33. Using **6 - 2" Metal Roof Screws** and **1/4" Nut Driver**, secure Metal Roof Panels down to lower Battens. Metal screws are self-tapping, do not overtighten!

Hardware
2" Metal Roof Screws
 x 6
1/4" Nut Driver
 x 1

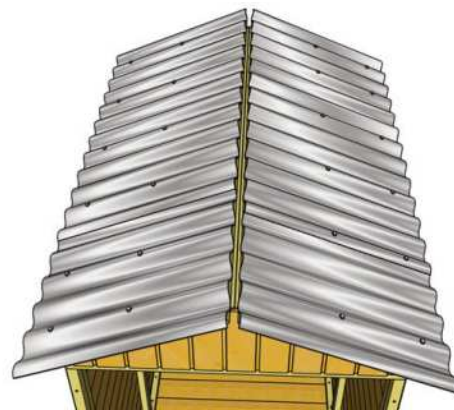

34. Complete the opposite side of the Roof with three remaining Metal Roof Panels and three Foam Enclosures, following **Steps 29 - 33**.

Parts
Metal Roof Panel (44") x 3
Foam Enclosures x 3

Hardware
2" Metal Roof Screws x 12
1/4" Nut Driver x 1

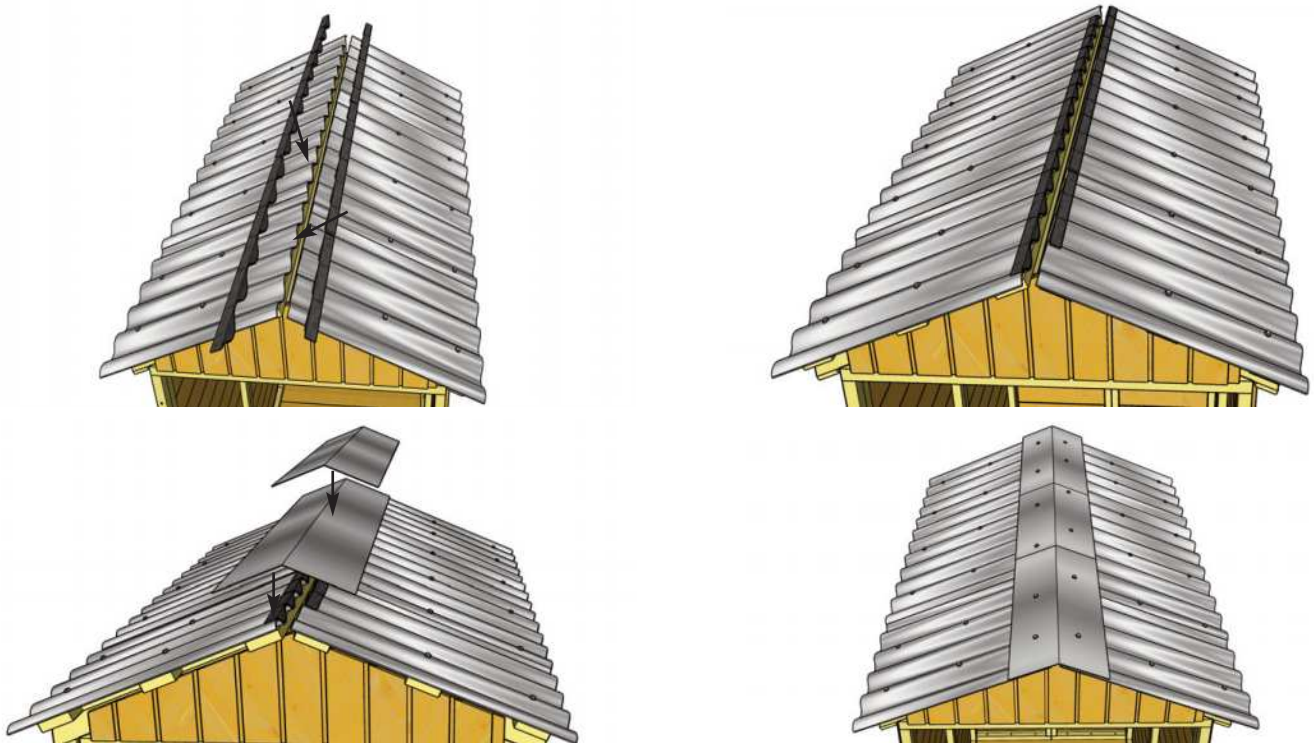

35. Locate **Foam Enclosures** and place 6 pieces on top of Metal Roof, to go underneath the **Metal Roof Ridge Cap**. Place Metal Roof Ridge Cap on top of Foam Enclosures and overhang approximately 1 1/8" at front and rear. When Metal Roof Ridge Cap is correctly positioned, secure with **12 - 2" Metal Screws**, using 1/4" Nut Driver as per **Step 31**. Screw into top most Batten on each side. Metal screws are self-tapping, do not overtighten!

<u>Parts</u> Metal Roof Ridge Cap (54") Foam Enclosures x 6	<u>Hardware</u> 2" Metal Screws x 12 total
---	---

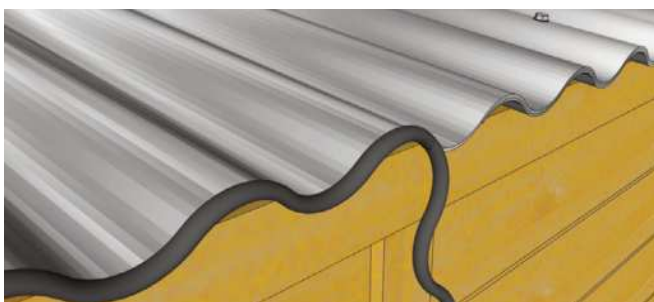

36. Locate **Metal Roof Edge Trim** and fit along the lower edge of the Metal Roof. When the edging is in place, use pliers to cut the end to the desired length. Complete on both sides.

<u>Parts</u> Metal Roof Edge Trim (54") x 2

D. Miscellaneous Section

Exploded view of all parts necessary to complete the Skirting, Trim, Fascia and Miscellaneous Pieces. Identify all parts prior to starting.

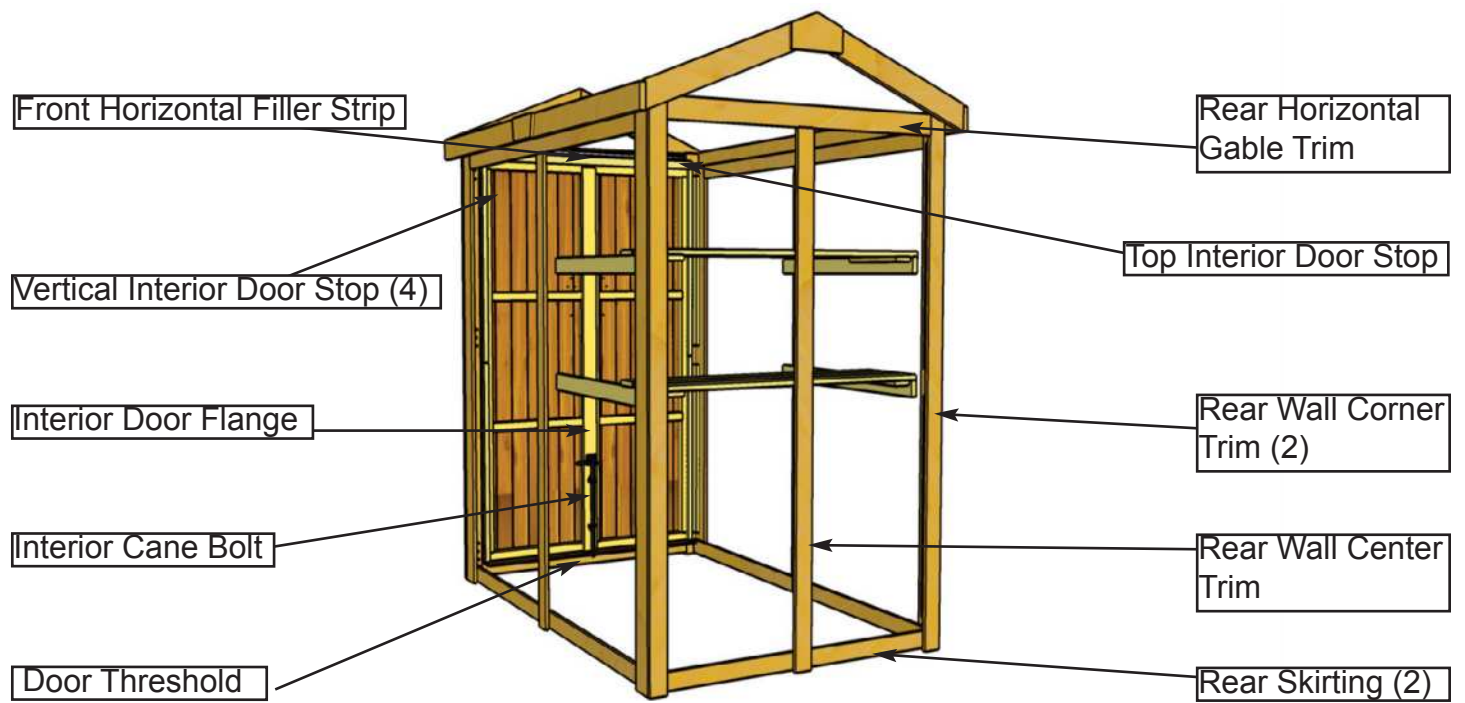
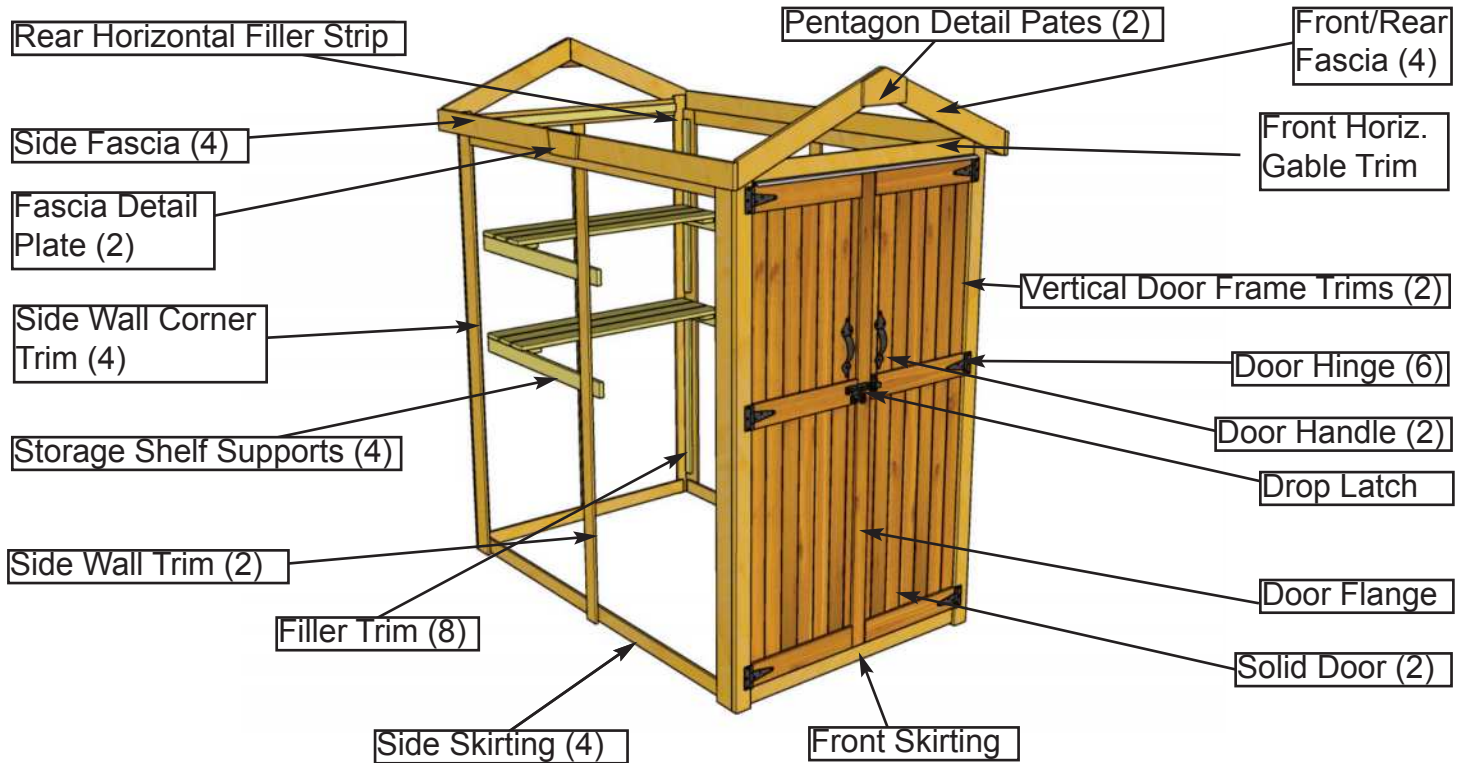



37. Check the wall seams for visible gaps prior to attaching Filler Trim and apply caulk where needed. Caulking gaps will help prevent moisture from entering and will help the longevity of your shed. **Caulking not included in kit.**

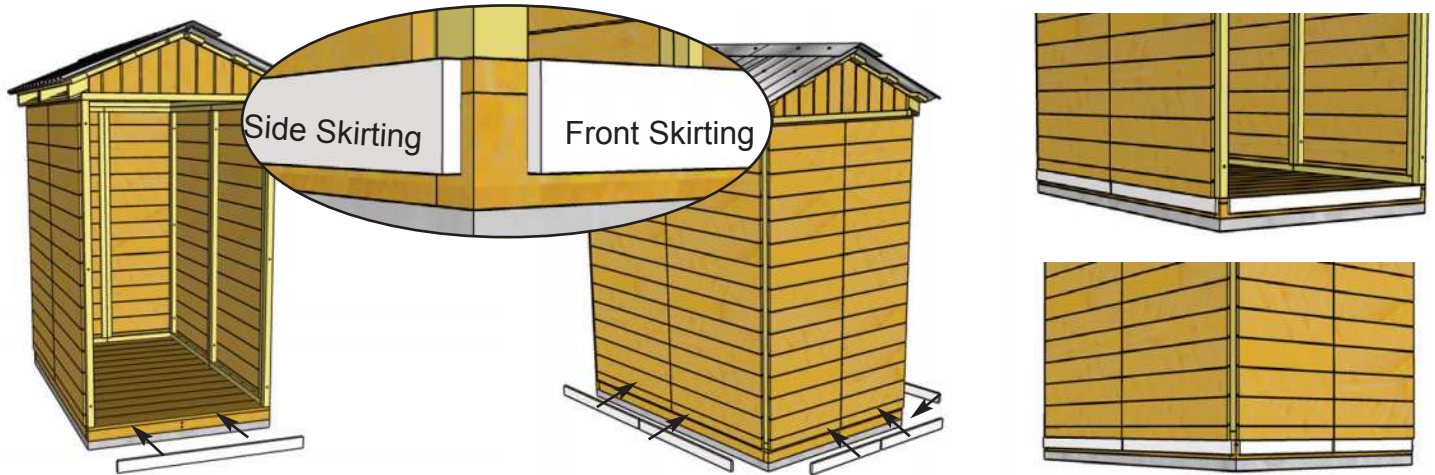

38. Locate **Lower Front Skirting**. Skirting will hide Floor framing. Gaps will be covered by Wide Trim Attach Front Skirting with **4 - 1 1/2" Finishing Nails**. Locate **Side Skirting** and attach with **4 - 1 1/2" Finishing Nails** per piece and **Rear Skirting** with **3 - 1 1/2" Finishing Nails** per piece.

Parts	Hardware
Front Skirting (1/2" x 2 1/2" x 42") Side Skirting (1/2" x 2 1/2" x 35 3/4") x 4 Rear Skirting (1/2" x 2 1/2" x 21 3/4") x 2	1 1/2" Finishing Nails x 26 total



39. Locate 4 **Front Filler Trims**. Filler trim will be covered by Corner Trim in **Step 43**. Attach in each front corner with **3 - 1 1/2" Finishing Nails** per piece.

Parts (Step 39 - 40)	Hardware (Step 39 - 40)
Front/Rear Filler Trims (5/8" x 1 1/2" x 33") x 8 total	1 1/2" Finishing Nails x 24 total



40. Position and attach **Rear Filler Trims** in the rear as per **Step 39**.

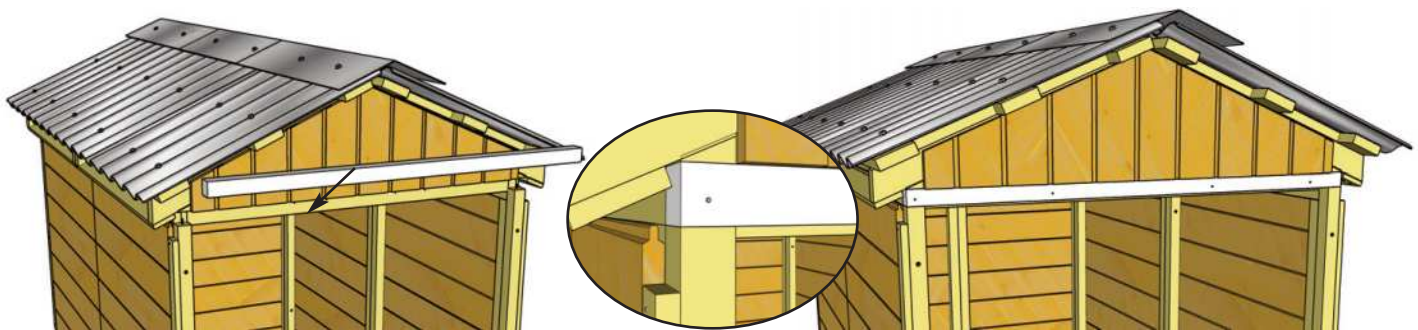

41. Locate **Front Horizontal Filler Strip**. Position Front Horizontal Filler Strip onto Door Header. Evenly space from side to side. Secure with **4 - 1 1/2" Finishing Nails** into Door Header.

<u>Parts</u> Front Horizontal Filler Strip (5/8" x 1 1/2" x 42")	<u>Hardware</u> 1 1/2" Finishing Nails x 4 total
---	---

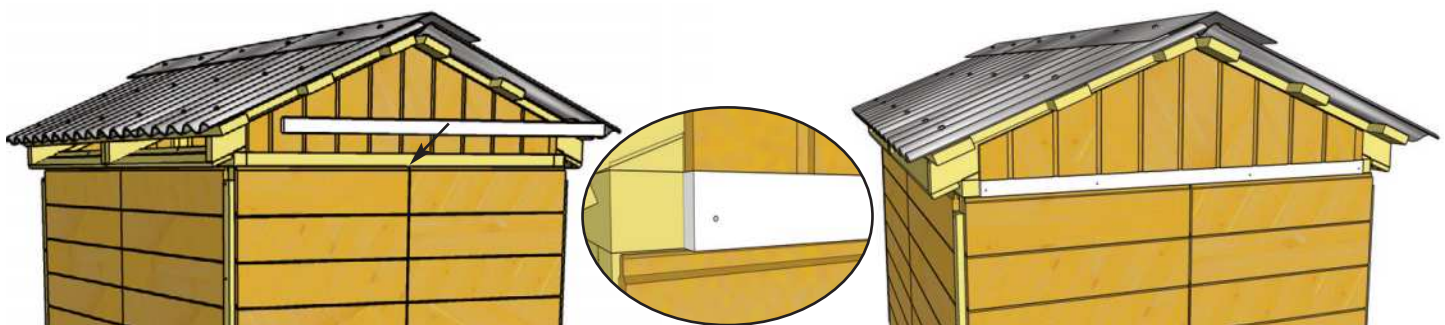

42. Locate **Rear Horizontal Filler Strip**. Position Rear Horizontal Filler Strip onto Rear Top Wall Plate. Evenly space from side to side. Secure with **4 - 1 1/2" Finishing Nails** into Rear Top Wall Plate.

<u>Parts</u> Rear Horizontal Filler Strip (5/8" x 1 1/2" x 42")	<u>Hardware</u> 1 1/2" Finishing Nails x 4 total
--	---



43. Locate **Roof Nailing Strips** and position under Rafter Edges at the Front and Rear. Attach to Rafter Edges with **3 - 1 1/4" Screws** each. Nailing Strips provide for a greater nailing surface later when you attach Front/Rear Fascia Trim.

<u>Parts</u> Roof Nailing Strips x 4	<u>Hardware</u> 1 1/4" Screws x 12 total
--	---



Expert Advice:
 Do a dry run with Front and Rear Corner Trims before attaching. Confirm the rough face is configured correctly and small trim gaps are satisfactory before attaching.

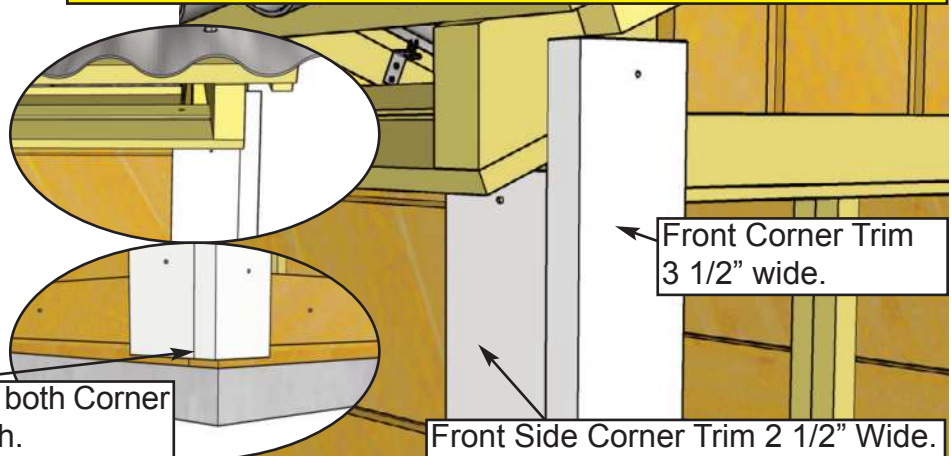

Align bottoms of both Corner Trim pieces flush.

Front Corner Trim 3 1/2" wide.

Front Side Corner Trim 2 1/2" Wide.

44. Locate a **Vertical Door Frame Trim** and **Side Wall Corner Trim**. Starting in one corner, position both Trims up underneath Metal Roof and Soffit. Align Vertical Door Frame Trim with bottom of Side Wall Corner Trim. Vertical Door Frame Trim will cap Side Wall Corner Trim. When correctly aligned, attach each piece with **6 - 1 1/2" Finishing Nails**.

<u>Parts</u> Vertical Door Frame Trim (1" x 2 5/8" x 78 1/2") Side Wall Corner Trim (1/2" x 3 1/2" x 76")	<u>Hardware</u> 1 1/2" Finishing Nails x 12 total
---	--

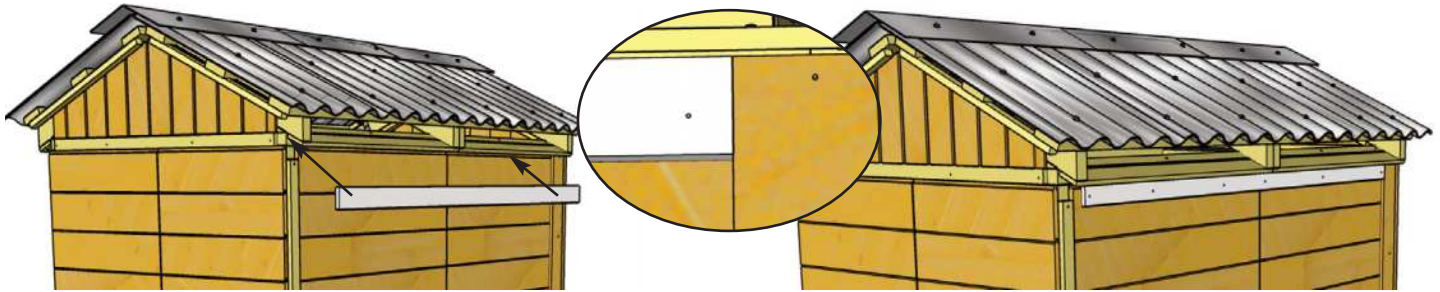

45. Locate **Upper Horizontal Side Wall Trim** and align tight against Side Wall Corner Trim. Attach with **6 - 1 1/2" Finishing Nails**.

<p><u>Parts</u> Upper Horizontal Side Wall Trim (1/2" x 2 1/2" x 66 5/8")</p>	<p><u>Hardware</u> 1 1/2" Finishing Nails x 6 total</p>
--	--

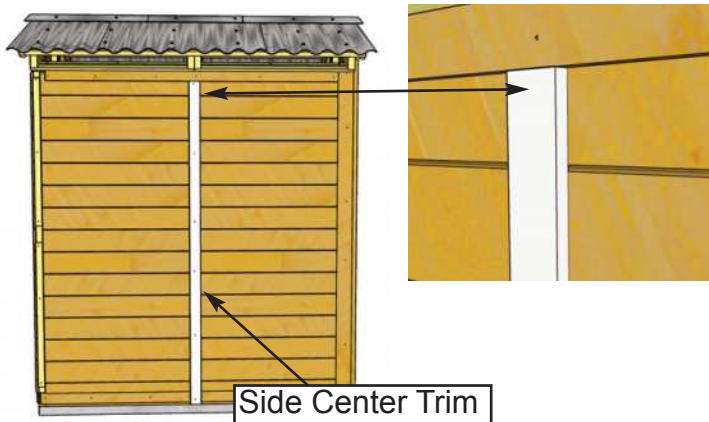

46. Locate **Side Wall Trim**. Place in the center of the two side walls. Attach trim close to the roof soffit with **6 - 1 1/2" Finishing Nails**.

<p><u>Parts</u> Side Wall Trim (1/2" x 2 1/2" x 73 1/2")</p>	<p><u>Hardware</u> 1 1/2" Finishing Nails x 6 total</p>
---	--

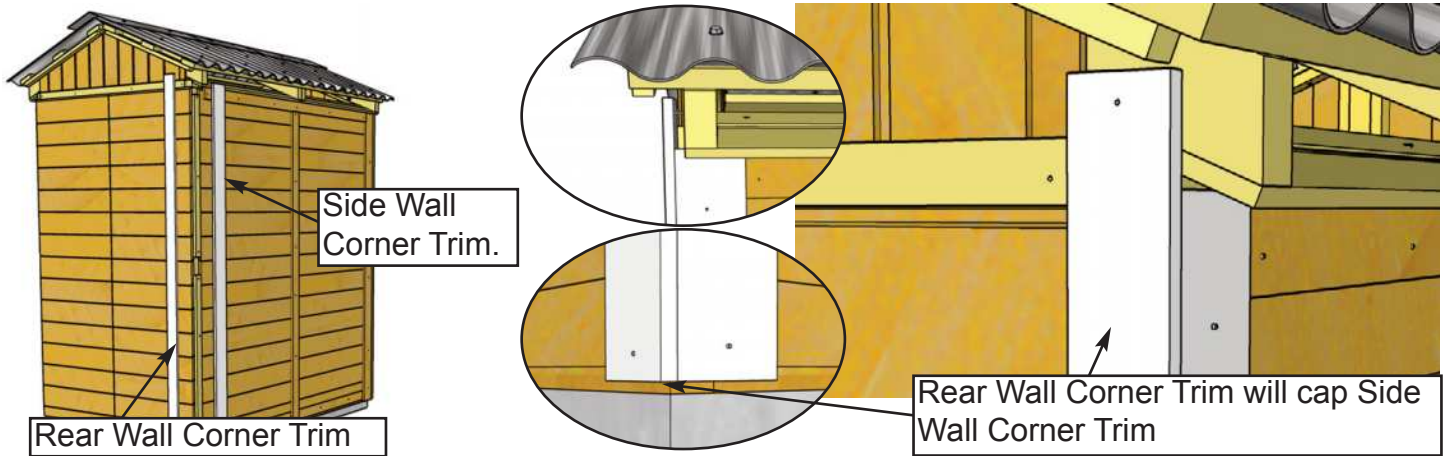

47. Locate a **Side Wall Corner Trim** and **Rear Wall Corner Trim** and position both Trims up underneath Metal Roof and Soffit. Align Rear Wall Corner Trim with bottom of Side Wall Corner Trim. Rear Wall Corner Trim will cap Side Wall Corner Trim. When correctly aligned, attach each piece with **6 - 1 1/2" Finishing Nails**.

<p><u>Parts</u> Rear Wall Corner Trim (1/2" x 2 1/2" x 78 1/2") Side Wall Corner Trim (1/2" x 3 1/2" x 76")</p>	<p><u>Hardware</u> 1 1/2" Finishing Nails x 12 total</p>
---	---

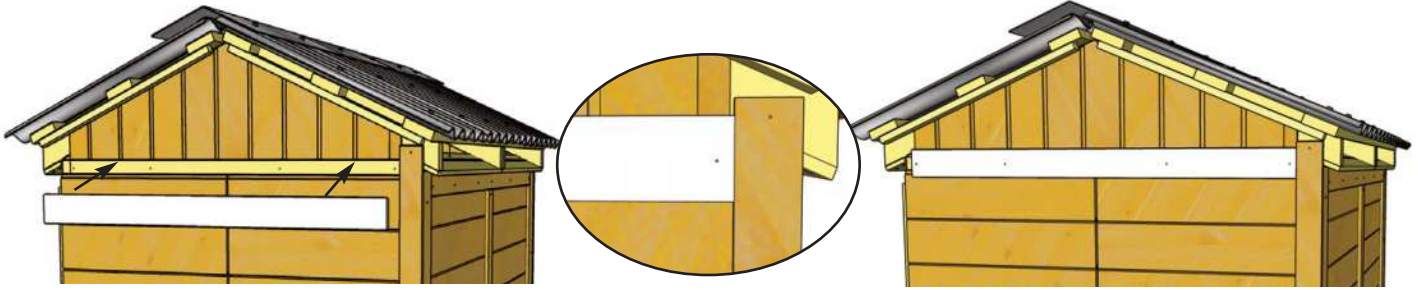

48. Locate **Rear Horizontal Gable Trim** and align tight against Rear Wall Corner Trim. Attach to Rear Horizontal Filler Strip with **4 - 1 1/2" Finishing Nails**.

<p><u>Parts</u> Rear Horizontal Gable Trim (1/2" x 3" x 42 1/4")</p>	<p><u>Hardware</u> 1 1/2" Finishing Nails x 4 total</p>
---	--

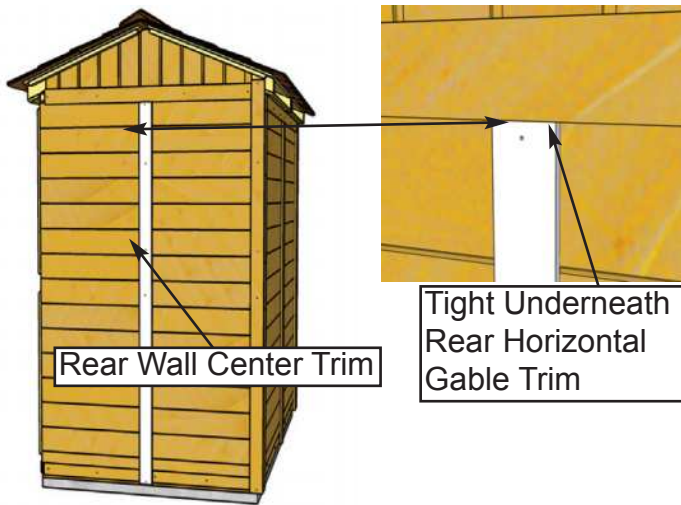

49. Locate **Rear Wall Center Trim**. Align tight against Upper Rear Horizontal Gable Trim and attach with **6 - 1 1/2" Finishing Nails**.

<p><u>Parts</u> Rear Wall Center Trim (1/2" x 2 1/2" x 74 3/4")</p>
<p><u>Hardware</u> 1 1/2" Finishing Nails x 6 total</p>



50. Complete other Rear and Front Corner Trims as per **Steps 44 - 47**.

<p><u>Parts</u> Rear Wall Corner Trim (1/2" x 2 1/2" x 78 1/2") Side Wall Corner Trim (1/2" x 3 1/2" x 76") x 2 Side Wall Trim (1/2" x 2 1/2" x 73 1/2") Upper Horizontal Side Wall Trim (1/2" x 2 1/2" x 42 1/4") Vertical Door Frame Trim (1" x 2 5/8" x 78 1/2")</p>
<p><u>Hardware</u> 1 1/2" Finishing Nails x 36 total</p>



51. Position **Rear Fascia** (angle cut on ends) and **Side Fascia** (square cut ends) in corner. Line Fascia up so Side Fascia caps Rear Fascia. Attach Rear Fascia to Nailing Strip with **5 - 1 1/2" Finishing Nails** and Side Fascia to ends of Rafters with **4 - 1 1/2" Finishing Nails**. Gap where Fascia boards come together at peak will be covered in **Step 53**. Do a dry run using Side Fascia to help you correctly position before attaching.

<p><u>Parts (Steps 51 - 52)</u></p> <p>Front & Rear Fascia (Angle Cut Both Ends) (3/4" x 3 1/2" x 27 1/4") x 4</p> <p>Side Fascia (3/4" x 3 1/2" x 39 5/8") x 2</p>	<p><u>Hardware (Steps 51 - 52)</u></p> <p>1 1/2" Finishing Nails x 36 total</p>
---	--

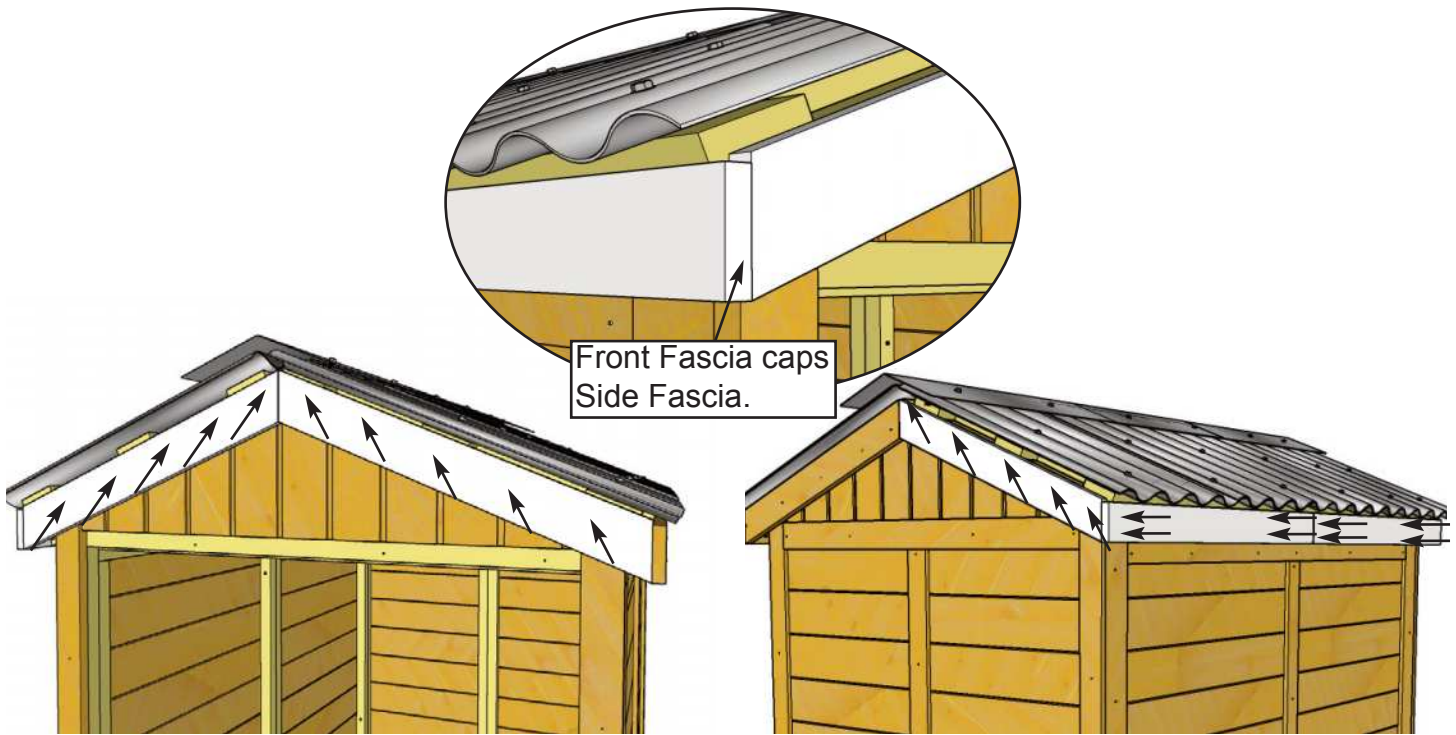

52. Attach remaining Front and Rear Fascia to Nailing Strips and attach remaining Side Fascia to Rafter ends as per **Step 51**.

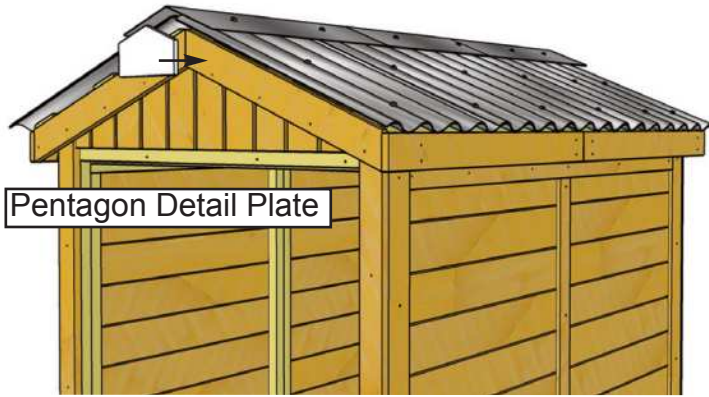

53. Attach **Pentagon Detail Plates** where Front and Rear Fascia Trims meet at the peak. Secure with **4 - 1 1/2" Finishing Nails** per piece.

<u>Parts</u> Pentagon Detail Plates (1/2" x 5" x 8") x 2	<u>Hardware</u> 1 1/2" Finishing Nails x 8 total
---	--

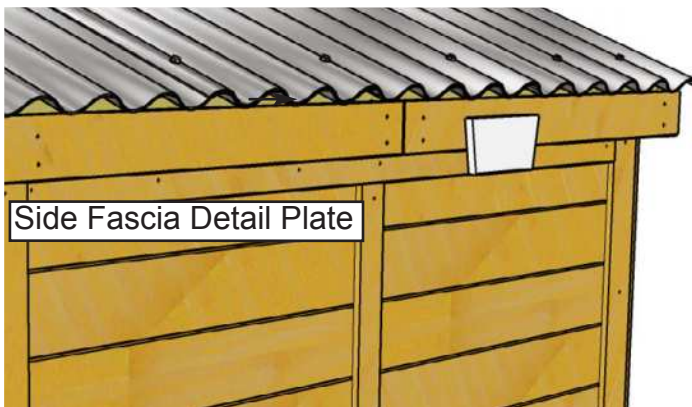

54. Attach **Side Fascia Detail Plates** where Side Fascia Trims meet in the middle. Secure with **4 - 1 1/2" Finishing Nails** per piece.

<u>Parts</u> Side Fascia Detail Plates (1/2" x 3 1/2" x 8") x 2	<u>Hardware</u> 1 1/2" Finishing Nails x 8 total
--	--

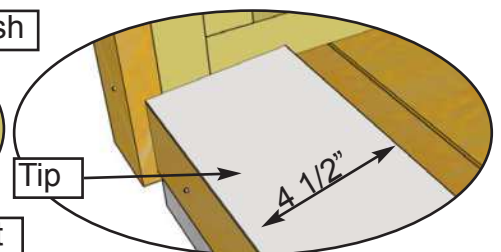
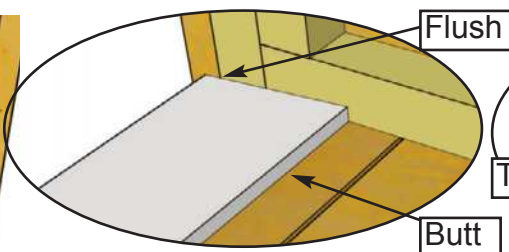
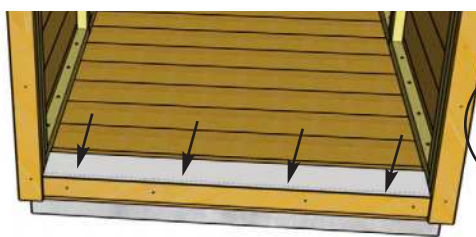

55. Locate **Door Threshold** and position on Floor at the opening. Align tip of the bevel flush with the outside of Bottom Wall Plate. Attach with **4 - 1 1/4" Brown Screws**.

<u>Parts</u> Door Threshold (Bevel) (1/2" x 4 1/2" x 42")	<u>Hardware</u> 1 1/4" Brown Screws x 4 total
--	--

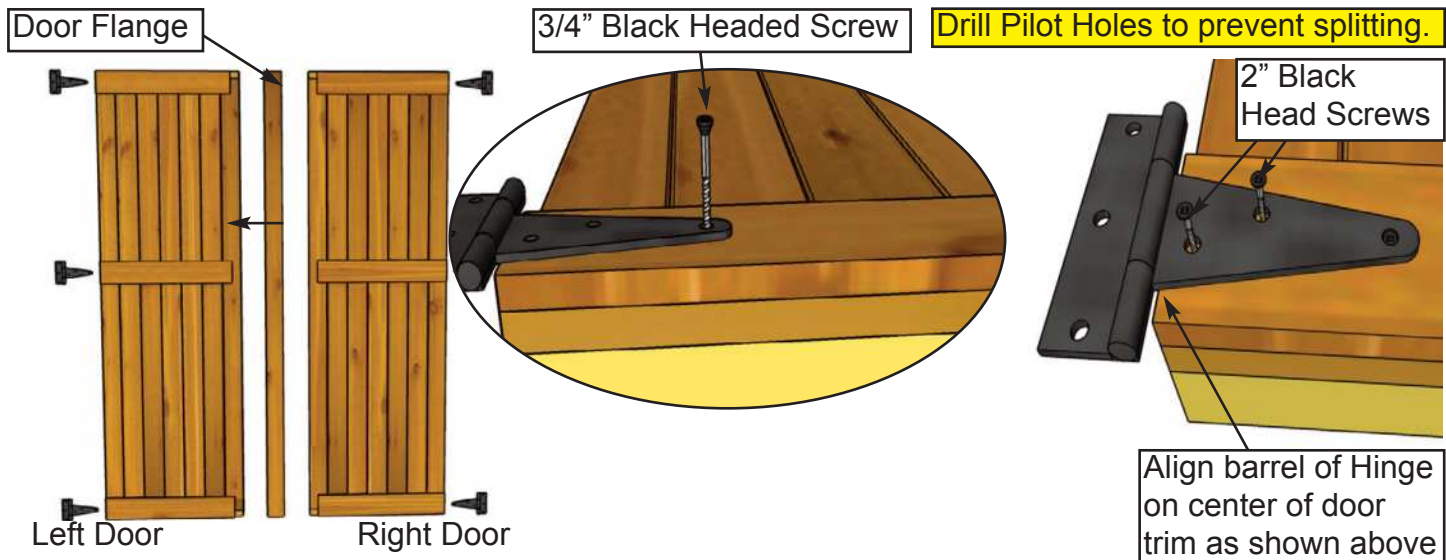

56. Locate **Left and Right Doors** and **Door Flange**. Orientate Doors so the outside of each Door is facing up. Locate **Black T Hinges**. Prior to attaching, position Hinges equally on Door trim as shown above and with a 1/8" drill bit, drill a hole through the tip of the Hinge and all the way through the Door. Complete for all 6 hinges. Attach each Hinge to Door as above with 1 - **3/4" Black Headed Screw**. Finish Hinge by securing with 2 - **2" Black Headed Screws**. Drill small pilot holes first to prevent wood from splitting. Complete both Doors (6 Hinges).

<p><u>Parts (Step 56 - 60)</u> Left and Right Doors (20 5/8" x 72") Door Flange (1/2" x 2 1/2" x 72")</p>	<p><u>Hardware (Step 56 - 60)</u> Black T Hinge x 6 total 3/4" Black Headed Screws x 6 total 1" Silver Screws x 6 total 2" Black Headed Screws x 30 total</p>
---	---

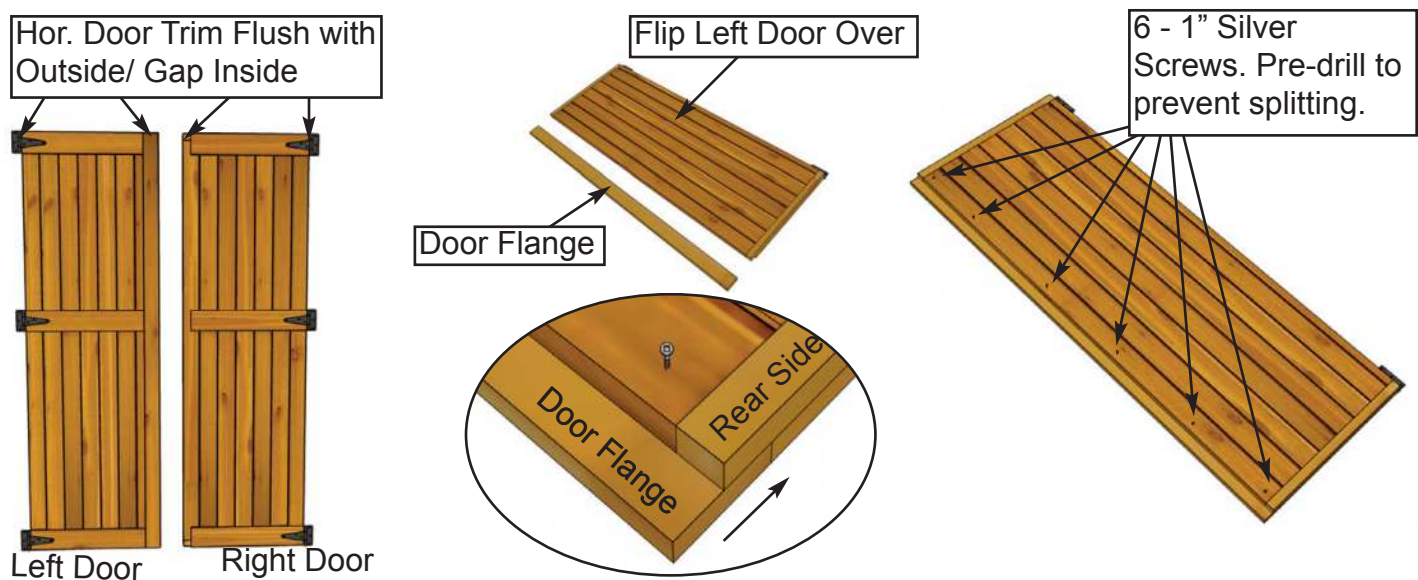

57. Flip Left Door over to attach **Door Flange**. Position Door Flange tight against horizontal trim and even with trim on top and bottom. If out slightly, make sure top horizontal trim and Flange are even. Pre-drill with 1/8" bit to prevent wood from splitting. Attach with 6 - **1" Silver Screws**.

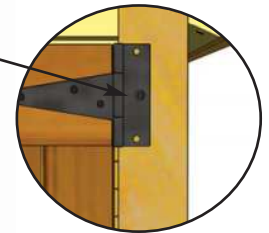
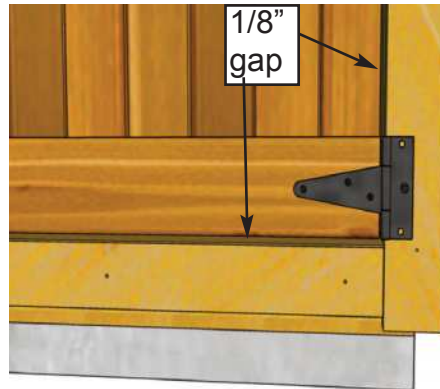

1 - 2" Screw per Hinge Initially.

58. Starting with Right Door first, lift and position Door in opening. Leave a 1/8" gap on right side and 1/8" gap on the bottom. Use a **Cedar Shingle Shim** to shim the Door at bottom to help position Door evenly. When Door is aligned correctly, screw Hinge into Vertical Door Frame Trim with **1 - 2" Black Headed Screw**. Use only 1 screw initially per Hinge until both Door alignments are confirmed. Drill pilot holes to prevent wood from splitting.



Left Side Door.



59. Position Left Side Door (with Flange) as per **Step 58**. Once again, use only **1 - 2" Black Headed Screw** per Hinge initially to secure door to Vertical Door Frame Trim.

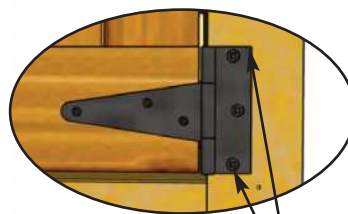

2 more - 2" Black Headed Screws per Hinge

60. With both Doors partially attached, check to see Doors open and close correctly. Make any necessary adjustments and when satisfied, completely secure Hinges to Vertical Door Frame Trim with **two more 2" Black Headed Screws** per Hinge. Drill pilot holes to prevent wood from splitting.

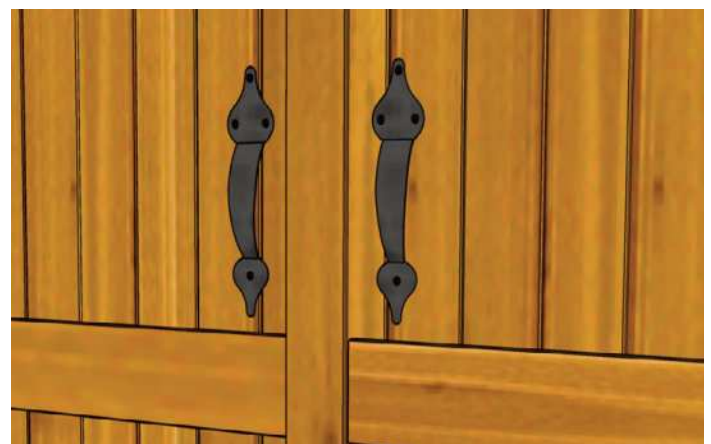

61. Attach **Door Handles** to Doors with **4 - 3/4" Black Headed Screws** per Handle. Choose desired Handle height.

Hardware
Black Handle x 2 total
3/4" Black Headed Screws x 8 total

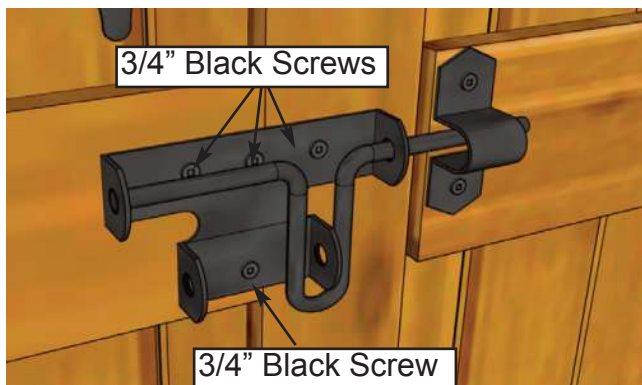

62. Attach **Black Drop Latch** as illustrated above with **6 - 3/4" Black Headed Screws**.
Note: Black Drop Latch receiver is positioned higher than male. Do a dry run first to position Black Drop Latch correctly. **Important** - Drill pilot holes with 1/8" drill bit prior to securing with screws to prevent wood splitting.

Hardware
Black Drop Latch
3/4" Black Headed Screws x 6 total

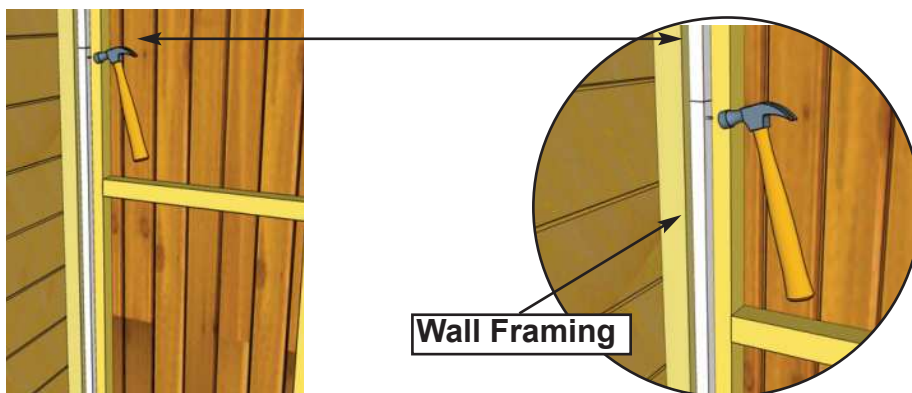

63. Attach **Interior Vertical Door Stops** to inside Wall framing with **4 - 1 1/2" Finishing Nails** per piece. To align correctly, close Door to make sure Stops are close to the Door but don't interfere with their closing. Attach bottom piece first with hammer.

<u>Parts (Step 63 - 64)</u> Interior Vertical Door Stops x 4 (3/4" x 3/4" x 29 7/8")	<u>Hardware (Step 63 - 64)</u> 1 1/2" Finishing Nails x 16 total
---	---

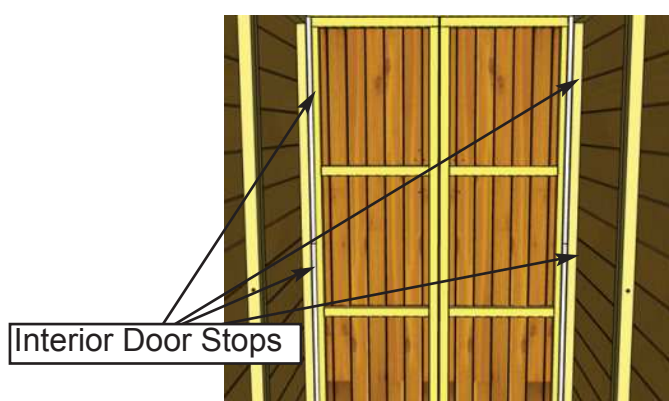
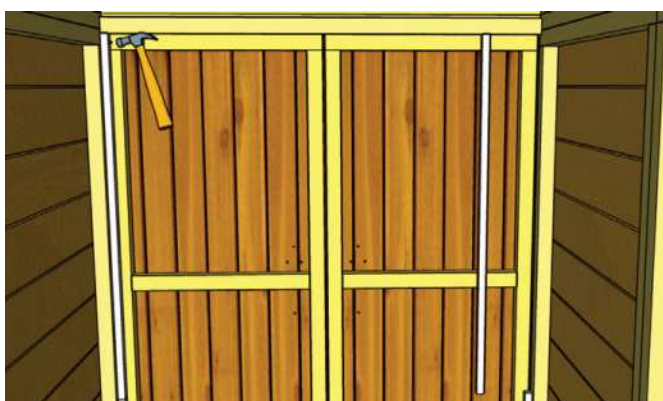

64. Attach top Interior Door Stop as per **Step 63** and then complete the opposite side.



65. Position **Top Interior Door Stop** on top of Interior Door Stops and attach to Door Header using **4 - 2" Brown Screws**.

Parts
Top Interior Door Stop
 (3/4" x 1 1/2" x 42") x 1

Hardware
2" Brown Screws
 x 4 total



66. Position and attach **Interior Door Flange** on inside edge of Door frame (**left door from outside**) using **6 - 2" Brown Screws**.

Parts
Interior Door Flange
 (1/2" x 2 1/2" x 71")

Hardware
2" Brown Screws
 x 6 total

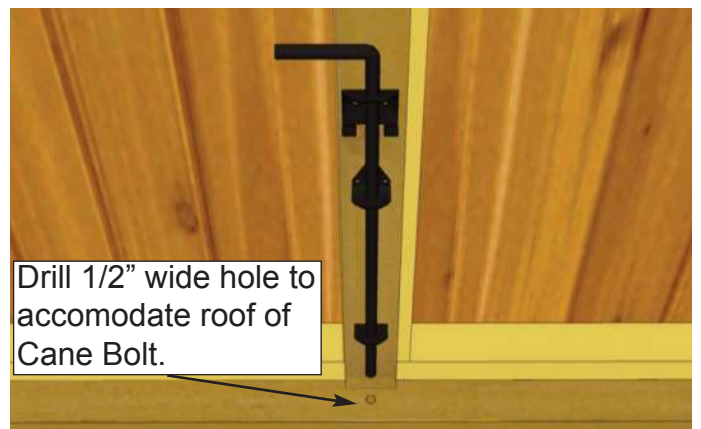
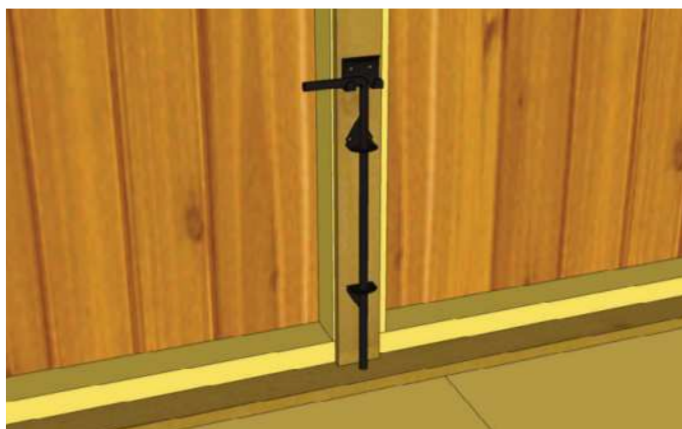

67. The Interior **Cane Bolt** will be attached to Interior Door Flange. To position Cane Bolt correctly, attach to Flange first, close Doors and mark hole to house Cane Bolt Rod. Open Doors and drill hole where previously marked with 1/2" bit. Attach Cane Bolt with **6 - 3/4" Black Screws**.

Hardware
Cane Bolt x 1 total
3/4" Black Screws
 x 6 total

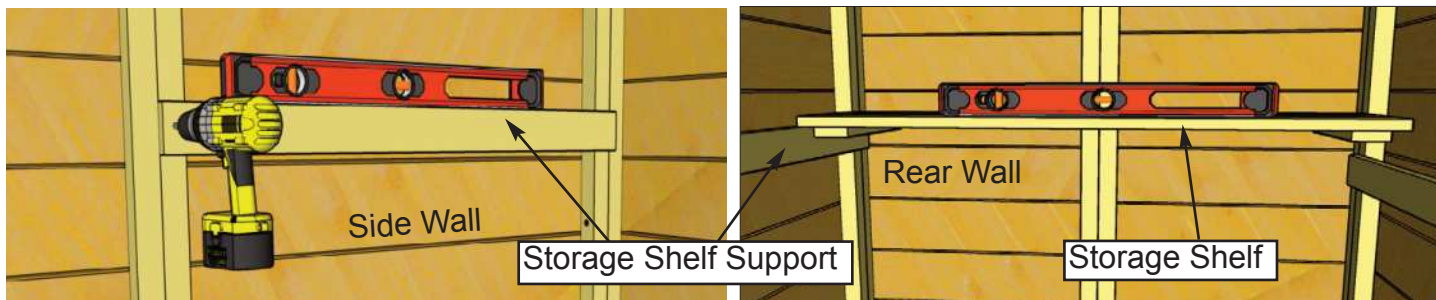

68. Storage Shelf positioning is flexible so decide what height configuration suits your needs. Gather your **Storage Shelf Supports**. Position using a Level, and drill Pilot Holes to prevent ends of Supports from splitting. Attach first Support using **2 - 1 1/4" Brown Screws**. Place **Storage Shelf** on attached Support, Level, and mark position of second Support. Pilot Hole and secure second Support.

<u>Parts (Steps 68 - 69)</u> Storage Shelf Supports (3/4" x 2 1/2" x 35") x 4 Storage Shelves (11 1/2" x 41 7/8") x 2	<u>Hardware Parts (Steps 68 - 69)</u> 1 1/4" Brown Screws x 8 total 1 1/2" Finishing Nails x 8 total
---	--

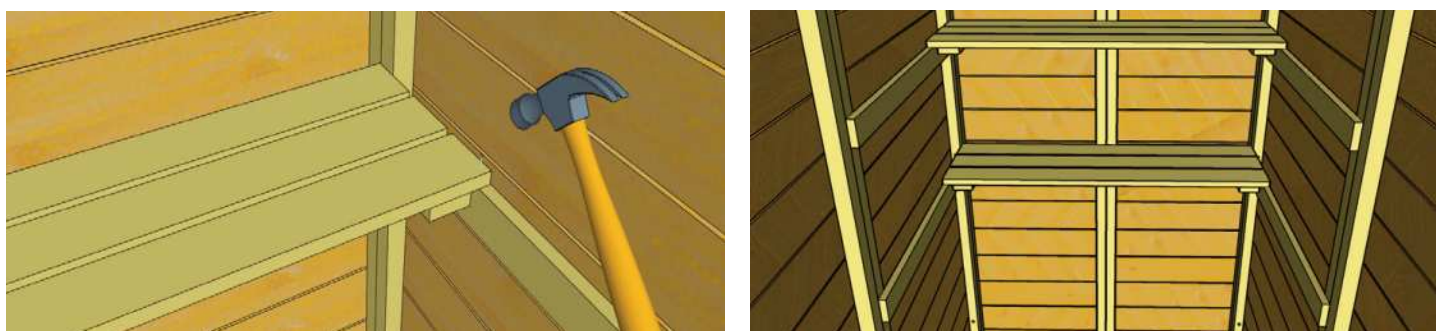

69. Place **Storage Shelf** on top of supports and secure with **4 - 1 1/2" Finishing Nails**. Complete 2nd Shelf (if desired) as per **Steps 68 & 69**.

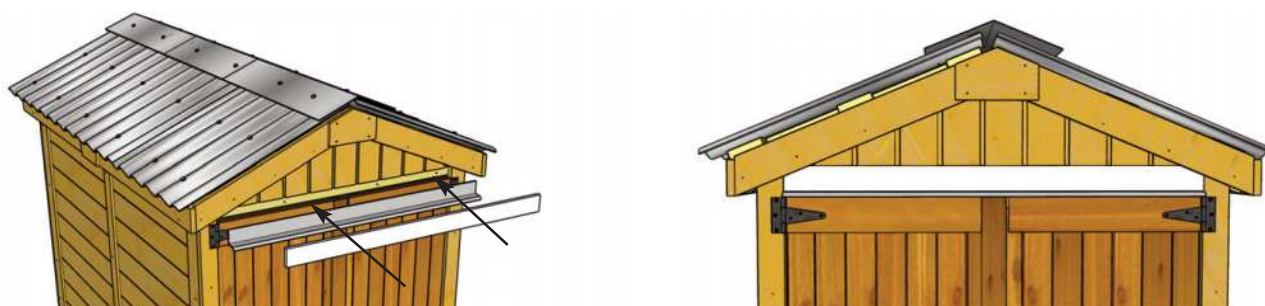

70. Locate **Front Horizontal Gable Trim** and **Metal Drip Edge**. Position Metal Drip Edge behind Gable Trim. Evenly space from side to side. While holding down both Metal Drip Edge and Front Horizontal Gable Trim, secure with **4 - 1 1/2" Finishing Nails** into Front Horizontal Filler Strip. Note: Confirm Metal Drip Edge is high enough to allow Doors to open and close correctly.

<u>Parts</u> Front Horizontal Gable Trim (1/2" x 2 1/2" x 42") Metal Drip Edge (41 7/8")	<u>Hardware</u> 1 1/2" Finishing Nails x 4 total
---	---



Note: Our Sheds are shipped as an unfinished product. If exposed to the elements, the lumber will weather to a silvery-gray color. If you prefer to keep the lumber looking closer to the original color, we suggest that you treat the wood with a good oil base wood stain. You may also wish to paint your new shed rather than stain it. In both cases we recommend that you consult with a paint and stain dealer in your area for their recommendations.

Congratulations on assembling your 6x4 Space Master!

We hope your experience constructing our **6x4 Space Master** has been both positive and rewarding. We value your feedback and would like to hear back from you on how well we are doing in the following areas:

- 1. Customer Service**
- 2. On Time Shipping**
- 3. Motor Freight Delivery**
- 4. Quality of Materials**
- 5. Assembly Manual**
- 6. Overall Satisfaction**



The materials contained in this Assembly Manual may be downloaded or copied provided that ALL copies retain the copyright and any other proprietary notices contained on the materials. No material may be modified, edited or taken out of context such that its use creates a false or misleading statement or impression as to the positions, statements or actions.

Please call, write or email us at:

Canadian Address
 9393 287th Street
 Maple Ridge, British Columbia
 Canada V2W 1L1

United States Address
 P.O. Box 96
 Sumas, Washington
 USA 98295

Toll Line: 1.888.658.1658 | Fax: 1.604.462.5333 | sales@outdoorlivingtoday.com